

Shasta-Tehama-Trinity Joint Community College District



**Shasta College**

California Environmental Reporting System  
Annual Resubmittal

**2026**

**Hazardous Materials Business Plan**

Shasta College  
Hazardous Materials  
Compliance Office

**Site Identification****Shasta Tehama Trinity Joint Community College**11555 Old Oregon Trail  
Redding, CA 96003County  
ShastaCERS ID  
**10490839**EPA ID Number  
CAD981689292**Submittal Status**Submitted on 3/4/2026 by *Joseph Trompczynski* of Shasta Tehama Trinity Joint Community College (Redding, CA)  
Submittal was **Accepted**; Processed on 3/6/2026 by *Paul McCarty* for Shasta County Environmental Health**Hazardous Materials**

Does your facility have on site (for any purpose) at any one time, hazardous materials at or above 55 gallons for liquids, 500 pounds for solids, or 200 cubic feet for compressed gases (include liquids in ASTs and USTs); or is regulated under more restrictive inventory local reporting requirements (shown below if present); or the applicable Federal threshold quantity for an extremely hazardous substance specified in 40 CFR Part 355, Appendix A or B; or handle radiological materials in quantities for which an emergency plan is required pursuant to 10 CFR Parts 30, 40 or 70?

**Yes****Underground Storage Tank(s) (UST)**

Does your facility own or operate underground storage tanks?

**Yes****Hazardous Waste**

Is your facility a Hazardous Waste Generator?

**Yes**

Does your facility treat hazardous waste on-site?

**No**

Is your facility's treatment subject to financial assurance requirements (for Permit by Rule and Conditional Authorization)?

**No**

Does your facility consolidate hazardous waste generated at a remote site?

**No**

Does your facility need to report the closure/removal of a tank that was classified as hazardous waste and cleaned on-site?

**No**

Does your facility generate in any single calendar month 1,000 kilograms (kg) (2,200 pounds) or more of federal RCRA hazardous waste, or generate in any single calendar month greater than 1 kg (2.2 pounds) of RCRA acute hazardous waste; or generate more than 100 kg (220 pounds) of spill cleanup materials contaminated with RCRA acute hazardous waste.

**No**

Is your facility a Household Hazardous Waste (HHW) Collection site?

**No****Excluded and/or Exempted Materials**

Does your facility recycle more than 100 kg/month of excluded or exempted recyclable materials (per HSC 25143.2)?

**No****Aboveground Petroleum Storage**

Does your facility own or operate aboveground petroleum storage tanks or containers AND:

\* have a total aboveground petroleum storage capacity of 1,320 gallons or more, OR

\* have one or more petroleum tanks in an underground area?

**Yes****Regulated Substances**

Does your facility have Regulated Substances stored onsite in quantities greater than the threshold quantities established by the California Accidental Release prevention Program (CalARP)?

**No****Additional Information**

No additional comments provided.

<b>Facility/Site</b>		CERS ID
<b>Shasta Tehama Trinity Joint Community College</b> 11555 Old Oregon Trail Redding, CA 96003		<b>10490839</b>

<b>Submittal Status</b>
Submitted on 3/4/2026 by <i>Joseph Trompczynski</i> of Shasta Tehama Trinity Joint Community College (Redding, CA) Submittal was <b>Accepted</b> ; Processed on 3/6/2026 by <i>Paul McCarty</i> for Shasta County Environmental Health

<b>Identification</b>					
Shasta Tehama Trinity Joint Community College			Beginning Date	Ending Date	
Operator Phone	Business Phone	Business Fax	Dun & Bradstreet	SIC Code	Primary NAICS
(530) 242-7510	(530) 242-7500	(530) 225-4994			

<b>Facility/Site Mailing Address</b>
P O Box 496006 Redding, CA 96049-6006

<b>Primary Emergency Contact</b>		
Frank Nigro		
Title District Superintendent / President		
Business Phone	24-Hour Phone	Pager Number
(530) 242-7510	(530) 229-4093	

<b>Owner</b>
Shasta Tehama Trinity Joint Community College (530) 242-2220 P O Box 496006 Redding, CA 96049-6006

<b>Secondary Emergency Contact</b>		
Lonnie Seay		
Title Chief of Campus Safety		
Business Phone	24-Hour Phone	Pager Number
(530) 242-7910	(530) 351-4134	

<b>Billing Contact</b>
Lonnie Seay (530) 242-7910 P O Box 496006 Redding, CA 96049-6006

<b>Environmental Contact</b>	
Joseph Trompczynski	
(530) 242-7948	jtrompczynski@shastacollege.edu
P O Box 496006 Redding, CA 96049-6006	

Name of Signer	Signer Title	Document Preparer
Lonnie Seay	Chief of Campus Safety	Joseph Trompczynski
Additional Information		

<b>Locally-collected Fields</b>					
Some or all of the following fields may be required by your local regulator(s).					
<table border="1"> <tr> <td><b>Property Owner</b></td> </tr> <tr> <td>Shasta Tehama Trinity Joint Community College</td> </tr> <tr> <td>Phone (530) 242-7500</td> </tr> <tr> <td>Mailing Address P O Box 496006 Redding, CA 96049-6006</td> </tr> </table>	<b>Property Owner</b>	Shasta Tehama Trinity Joint Community College	Phone (530) 242-7500	Mailing Address P O Box 496006 Redding, CA 96049-6006	Assessor Parcel Number (APN) 076-030-008 Number of Employees  Facility ID 45-000-000858
<b>Property Owner</b>					
Shasta Tehama Trinity Joint Community College					
Phone (530) 242-7500					
Mailing Address P O Box 496006 Redding, CA 96049-6006					

## Hazardous Materials And Wastes Inventory Matrix Report

CERS Business/Org. <b>Shasta Tehama Trinity Joint Community College</b> Facility Name <b>Shasta Tehama Trinity Joint Community College</b> 11555 Old Oregon Trail, Redding 96003	Chemical Location <b>BLDG 0300</b>	CERS ID <b>10490839</b> Facility ID <b>45-000-000858</b> Status <b>Submitted on 3/4/2026 4:23 PM</b>
--	---------------------------------------	--

DOT Code/Fire Haz. Class	Common Name	Unit	Quantities			Annual Waste Amount	Federal Hazard Categories	Hazardous Components (For mixture only)		
			Max. Daily	Largest Cont.	Avg. Daily			Component Name	% Wt	EHS CAS No.
	<b>CLAY</b> <small>CAS No</small> Map: 300 Grid: D8	<b>Pounds</b> <small>State</small> Solid <small>Type</small> Mixture	<b>7500</b> <small>Storage Container</small> Box <small>Days on Site: 365</small>	<b>50</b>	3500 <small>Pressue</small> Ambient <small>Temperature</small> Ambient		- Health Carcinogenicity	Silica, crystalline	41%	74862
DOT: 2.2 - Nonflammable Gases	<b>ARGON/CARBON DIOXIDE</b> <small>CAS No</small> Map: 300 Grid: E7	<b>Cu. Feet</b> <small>State</small> Gas <small>Type</small> Mixture	<b>546</b> <small>Storage Container</small> Cylinder <small>Days on Site: 365</small>	<b>296</b>	546 <small>Pressue</small> > Ambient <small>Temperature</small> Ambient		- Physical Gas Under Pressure - Health Simple Asphyxiant	Argon Carbon Dioxide	75% 25%	7440371 124389
DOT: 2.1 - Flammable Gases	<b>PROPANE</b> <small>CAS No</small> 74986 Map: 300 Grid: E7	<b>Gallons</b> <small>State</small> Gas <small>Type</small> Pure	<b>11</b> <small>Storage Container</small> Cylinder <small>Days on Site: 365</small>	<b>5</b>	7 <small>Pressue</small> > Ambient <small>Temperature</small> Ambient		- Physical Flammable - Physical Gas Under Pressure - Health Simple Asphyxiant	Propane	100%	74986
DOT: 5.1 - Oxidizing Substances	<b>OXYGEN</b> <small>CAS No</small> 7782447 Map: 300 Grid: E7	<b>Cu. Feet</b> <small>State</small> Gas <small>Type</small> Pure	<b>890</b> <small>Storage Container</small> Cylinder <small>Days on Site: 365</small>	<b>336</b>	890 <small>Pressue</small> > Ambient <small>Temperature</small> Ambient		- Physical Gas Under Pressure - Physical Oxidizer	Oxygen, Compressed	100%	7782447
DOT: 2.2 - Nonflammable Gases	<b>ARGON</b> <small>CAS No</small> 7440371 Map: 300 Grid: E7	<b>Cu. Feet</b> <small>State</small> Gas <small>Type</small> Pure	<b>308</b> <small>Storage Container</small> Cylinder <small>Days on Site: 365</small>	<b>308</b>	308 <small>Pressue</small> > Ambient <small>Temperature</small> Ambient		- Physical Gas Under Pressure - Health Simple Asphyxiant	Argon	100%	7440371
DOT: 2.1 - Flammable Gases	<b>ACETYLENE</b> <small>CAS No</small> 74862 Map: 300 Grid: E7	<b>Cu. Feet</b> <small>State</small> Gas <small>Type</small> Pure	<b>600</b> <small>Storage Container</small> Cylinder <small>Days on Site: 365</small>	<b>440</b>	600 <small>Pressue</small> > Ambient <small>Temperature</small> Ambient		- Physical Flammable - Physical Gas Under Pressure - Health Simple Asphyxiant	Acetylene	100%	74862

## Hazardous Materials And Wastes Inventory Matrix Report

CERS Business/Org. <b>Shasta Tehama Trinity Joint Community College</b>	Chemical Location <b>BLDG 0300, OUTSIDE</b>	CERS ID <b>10490839</b>
Facility Name <b>Shasta Tehama Trinity Joint Community College</b> 11555 Old Oregon Trail, Redding 96003		Facility ID <b>45-000-000858</b>
		Status <b>Submitted on 3/4/2026 4:23 PM</b>

DOT Code/Fire Haz. Class	Common Name	Unit	Quantities			Annual Waste Amount	Federal Hazard Categories	Hazardous Components (For mixture only)		
			Max. Daily	Largest Cont.	Avg. Daily			Component Name	% Wt	EHS CAS No.
	<b>CERAMIC MATERIALS AND WARES, CHEMICALS</b>	<b>Pounds</b>	<b>1300</b>	<b>100</b>	<b>1300</b>		- Health	Quartz	60%	14808-60-7
	<u>CAS No</u> 66402-68-4	<u>State</u> Solid	<u>Storage Container</u> Bag		<u>Pressue</u> Ambient	<u>Waste Code</u>	Carcinogenicity	Aluminum oxide	30%	1344-28-1
	Map: 300 Grid: C6	<u>Type</u> Pure	Days on Site: 365		<u>Temperature</u> Ambient		- Health Skin	Iron oxide	5%	1309-37-1
							Corrosion	Titanium dioxide	3%	13463-67-7
							Irritation	Potassium oxide	2%	12136-45-7
							- Health Serious			
							Eye Damage Eye			
							Irritation			
							- Health Specific			
							Target Organ			
							Toxicity			

## Hazardous Materials And Wastes Inventory Matrix Report

CERS Business/Org. <b>Shasta Tehama Trinity Joint Community College</b>	Chemical Location <b>BLDG 0500</b>	CERS ID <b>10490839</b>
Facility Name <b>Shasta Tehama Trinity Joint Community College</b> 11555 Old Oregon Trail, Redding 96003		Facility ID <b>45-000-000858</b>
		Status <b>Submitted on 3/4/2026 4:23 PM</b>

DOT Code/Fire Haz. Class	Common Name	Unit	Quantities			Annual Waste Amount	Federal Hazard Categories	Hazardous Components (For mixture only)		
			Max. Daily	Largest Cont.	Avg. Daily			Component Name	% Wt	EHS CAS No.
	<b>MISCELLANEOUS PAINT</b>	<b>Gallons</b>	<b>80</b>	<b>5</b>	<b>45</b>		- Health	Titanium Dioxide		13463677
	<u>CAS No</u>	<u>State</u>	<u>Storage Container</u>		<u>Pressue</u>	<u>Waste Code</u>	Carcinogenicity	Silica, Crystalline		7631869
		Liquid	Plastic/Non-metalic Drum		Ambient		- Health Specific	NEPHELINE SYENITE		12736-96-8
	Map: 500 Grid: H2	<u>Type</u>			<u>Temperature</u>		Target Organ	Diatomaceous Earth		68855549
		Mixture	Days on Site: 365		Ambient		Toxicity			



## Hazardous Materials And Wastes Inventory Matrix Report

CERS Business/Org. <b>Shasta Tehama Trinity Joint Community College</b>	Chemical Location <b>BLDG 1200</b>	CERS ID <b>10490839</b>
Facility Name <b>Shasta Tehama Trinity Joint Community College</b> 11555 Old Oregon Trail, Redding 96003		Facility ID <b>45-000-000858</b>
		Status <b>Submitted on 3/4/2026 4:23 PM</b>

DOT Code/Fire Haz. Class	Common Name	Unit	Quantities			Annual Waste Amount	Federal Hazard Categories	Hazardous Components (For mixture only)		
			Max. Daily	Largest Cont.	Avg. Daily			Component Name	% Wt	EHS CAS No.
DOT: 2.2 - Nonflammable Gases	<b>ARGON/CARBON DIOXIDE</b>	<b>Cu. Feet</b>	<b>516</b>	<b>336</b>	<b>300</b>		- Physical Gas Under Pressure - Health Simple Asphyxiant	Argon Carbon Dioxide	75% 25%	7440371 124389
	<u>CAS No</u>	<u>State</u>	<u>Storage Container</u>		<u>Pressue</u>	<u>Waste Code</u>				
	Map: 1200 Grid: E5	Gas	Cylinder		> Ambient					
		<u>Type</u>			<u>Temperature</u>					
		Mixture	Days on Site: 365		Ambient					
DOT: 5.1 - Oxidizing Substances	<b>OXYGEN</b>	<b>Cu. Feet</b>	<b>312</b>	<b>156</b>	<b>160</b>		- Physical Gas Under Pressure - Physical Oxidizer	Oxygen, Compressed	100%	7782447
Oxidizing Gas, Gaseous	<u>CAS No</u>	<u>State</u>	<u>Storage Container</u>		<u>Pressue</u>	<u>Waste Code</u>				
	7782447	Gas	Cylinder		> Ambient					
	Map: 1200 Grid: E5	<u>Type</u>			<u>Temperature</u>					
		Pure	Days on Site: 365		Ambient					
DOT: 2.2 - Nonflammable Gases	<b>ARGON</b>	<b>Cu. Feet</b>	<b>562</b>	<b>281</b>	<b>320</b>		- Physical Gas Under Pressure - Health Simple Asphyxiant	Argon	100%	7440371
	<u>CAS No</u>	<u>State</u>	<u>Storage Container</u>		<u>Pressue</u>	<u>Waste Code</u>				
	7440371	Gas	Cylinder		> Ambient					
	Map: 1200 Grid: E5	<u>Type</u>			<u>Temperature</u>					
		Pure	Days on Site: 365		Ambient					
DOT: 2.1 - Flammable Gases	<b>ACETYLENE</b>	<b>Cu. Feet</b>	<b>127</b>	<b>127</b>	<b>70</b>		- Physical Flammable - Physical Gas Under Pressure - Health Simple Asphyxiant	Acetylene	100%	74862
Unstable (Reactive), Class 2, Flammable Gas	<u>CAS No</u>	<u>State</u>	<u>Storage Container</u>		<u>Pressue</u>	<u>Waste Code</u>				
	74862	Gas	Cylinder		> Ambient					
	Map: 1200 Grid: E5	<u>Type</u>			<u>Temperature</u>					
		Pure	Days on Site: 365		Ambient					
DOT: 3 - Flammable and Combustible Liquids	<b>MISCELLANEOUS PAINT/STAIN</b>	<b>Gallons</b>	<b>45</b>	<b>5</b>	<b>30</b>		- Physical Flammable - Physical Gas Under Pressure - Health Carcinogenicity - Health Reproductive Toxicity - Health Skin Corrosion Irritation - Health Respiratory Skin Sensitization - Health Serious Eye Damage Eye Irritation - Health Specific Target Organ Toxicity - Health Aspiration Hazard - Health Germ Cell Mutagenicity	Acetone Stoddard Solvent Hydrotreated Light Distillate Hydrotreated heavy naphtha, petroleum		67641 8030306 64742478 64742489
	<u>CAS No</u>	<u>State</u>	<u>Storage Container</u>		<u>Pressue</u>	<u>Waste Code</u>				
		Liquid	Plastic/Non-metalic Drum, Can, Plastic Bottle or Jug		Ambient					
	Map: 1200 Grid: C7	<u>Type</u>			<u>Temperature</u>					
		Mixture	Days on Site: 365		Ambient					

## Hazardous Materials And Wastes Inventory Matrix Report

CERS Business/Org. <b>Shasta Tehama Trinity Joint Community College</b> Facility Name <b>Shasta Tehama Trinity Joint Community College</b> 11555 Old Oregon Trail, Redding 96003	Chemical Location <b>BLDG 1200, OUTSIDE</b>	CERS ID <b>10490839</b> Facility ID <b>45-000-000858</b> Status <b>Submitted on 3/4/2026 4:23 PM</b>
--	--	--

DOT Code/Fire Haz. Class	Common Name	Unit	Quantities			Annual Waste Amount	Federal Hazard Categories	Hazardous Components (For mixture only)		
			Max. Daily	Largest Cont.	Avg. Daily			Component Name	% Wt	EHS CAS No.
DOT: 2.2 - Nonflammable Gases	<b>ARGON/CARBON DIOXIDE</b>	<b>Cu. Feet</b>	<b>672</b>	<b>336</b>	<b>438</b>		- Physical Gas Under Pressure - Health Simple Asphyxiant	Argon Carbon Dioxide	75% 25%	7440371 124389
	<u>CAS No</u>	<u>State</u>	<u>Storage Container</u>		<u>Pressue</u>	<u>Waste Code</u>				
	Map: 1200 Grid: E2	Gas	Cylinder		> Ambient					
		<u>Type</u>	<u>Mixture</u>	Days on Site: 365	<u>Temperature</u>					
		Pure			Ambient					
DOT: 5.1 - Oxidizing Substances	<b>OXYGEN</b>	<b>Cu. Feet</b>	<b>843</b>	<b>281</b>	<b>615</b>		- Physical Gas Under Pressure - Physical Oxidizer	Oxygen, Compressed	100%	7782447
Oxidizing Gas, Gaseous	<u>CAS No</u>	<u>State</u>	<u>Storage Container</u>		<u>Pressue</u>	<u>Waste Code</u>				
	Map: 1200 Grid: E2	Gas	Cylinder		> Ambient					
		<u>Type</u>	<u>Mixture</u>	Days on Site: 365	<u>Temperature</u>					
		Pure			Ambient					
DOT: 2.2 - Nonflammable Gases	<b>ARGON</b>	<b>Cu. Feet</b>	<b>281</b>	<b>281</b>	<b>205</b>		- Physical Gas Under Pressure - Health Simple Asphyxiant	Argon	100%	7440371
	<u>CAS No</u>	<u>State</u>	<u>Storage Container</u>		<u>Pressue</u>	<u>Waste Code</u>				
	Map: 1200 Grid: E2	Gas	Cylinder		> Ambient					
		<u>Type</u>	<u>Mixture</u>	Days on Site: 365	<u>Temperature</u>					
		Pure			Ambient					
DOT: 2.1 - Flammable Gases	<b>ACETYLENE</b>	<b>Cu. Feet</b>	<b>769</b>	<b>245</b>	<b>410</b>		- Physical Flammable - Physical Gas Under Pressure - Health Simple Asphyxiant	Acetylene	100%	74862
Unstable (Reactive), Class 2, Flammable Gas	<u>CAS No</u>	<u>State</u>	<u>Storage Container</u>		<u>Pressue</u>	<u>Waste Code</u>				
	Map: 1200 Grid: E2	Gas	Cylinder		> Ambient					
		<u>Type</u>	<u>Mixture</u>	Days on Site: 365	<u>Temperature</u>					
		Pure			Ambient					
DOT: 3 - Flammable and Combustible Liquids	<b>DIESEL #2</b>	<b>Gallons</b>	<b>190</b>	<b>108</b>	<b>130</b>		- Physical Flammable - Health Carcinogenicity - Health Acute Toxicity - Health Skin Corrosion Irritation - Health Specific Target Organ Toxicity - Health Aspiration Hazard	Diesel Fuel No. 2	100%	68476-34-6
Combustible Liquid, Class II	<u>CAS No</u>	<u>State</u>	<u>Storage Container</u>		<u>Pressue</u>	<u>Waste Code</u>				
	Map: 1200 Grid: G8	Liquid	Other		Ambient					
		<u>Type</u>	<u>Mixture</u>	Days on Site: 365	<u>Temperature</u>					
		Pure			Ambient					
DOT: 3 - Flammable and Combustible Liquids	<b>Motor Oil/Hydraulic Oil/Gear Oil</b>	<b>Gallons</b>	<b>265</b>	<b>55</b>	<b>150</b>			Lubricating Oil	100%	8020835
Combustible Liquid, Class III-B	<u>CAS No</u>	<u>State</u>	<u>Storage Container</u>		<u>Pressue</u>	<u>Waste Code</u>				
	Map: 1200 Grid: D2	Liquid	Steel Drum		Ambient					
		<u>Type</u>	<u>Mixture</u>	Days on Site: 365	<u>Temperature</u>					
		Pure			Ambient					

## Hazardous Materials And Wastes Inventory Matrix Report

CERS Business/Org. <b>Shasta Tehama Trinity Joint Community College</b>	Chemical Location <b>BLDG 1200, OUTSIDE</b>	CERS ID <b>10490839</b>
Facility Name <b>Shasta Tehama Trinity Joint Community College</b> 11555 Old Oregon Trail, Redding 96003		Facility ID <b>45-000-000858</b>
		Status <b>Submitted on 3/4/2026 4:23 PM</b>

DOT Code/Fire Haz. Class	Common Name	Unit	Quantities			Annual Waste Amount	Federal Hazard Categories	Hazardous Components (For mixture only)		
			Max. Daily	Largest Cont.	Avg. Daily			Component Name	% Wt	EHS CAS No.
DOT: 3 - Flammable and Combustible Liquids Flammable Liquid, Class I-B	<b>Gasoline</b>  CAS No 86290-81-5	<b>Gallons</b>	<b>55</b>	<b>55</b>	<b>30</b>		- Physical Flammable - Health Carcinogenicity - Health Reproductive Toxicity - Health Skin Corrosion Irritation - Health Respiratory Skin Sensitization - Health Serious Eye Damage Eye Irritation - Health Specific Target Organ Toxicity - Health Aspiration Hazard - Health Germ Cell Mutagenicity			
		State Liquid Type Mixture	Storage Container Steel Drum		Pressue Ambient Temperature Ambient	Waste Code				

## Hazardous Materials And Wastes Inventory Matrix Report

CERS Business/Org. <b>Shasta Tehama Trinity Joint Community College</b> Facility Name <b>Shasta Tehama Trinity Joint Community College</b> 11555 Old Oregon Trail, Redding 96003	Chemical Location <b>BLDG 1400, OUTSIDE</b>	CERS ID <b>10490839</b> Facility ID <b>45-000-000858</b> Status <b>Submitted on 3/4/2026 4:23 PM</b>
--	--	--

DOT Code/Fire Haz. Class	Common Name	Unit	Quantities			Annual Waste Amount	Federal Hazard Categories	Hazardous Components (For mixture only)		
			Max. Daily	Largest Cont.	Avg. Daily			Component Name	% Wt	EHS CAS No.
Combustible Liquid, Class III-B	<b>TRANSFORMER OIL</b>	<b>Gallons</b>	<b>440</b>	<b>440</b>	<b>440</b>		- Health Aspiration Hazard	Mineral Oil	100%	8020835
	<u>CAS No</u>	<u>State</u>	<u>Storage Container</u>	<u>Pressue</u>	<u>Waste Code</u>					
	64742-53-6	Liquid	Other	Ambient						
	Map: 1 Grid: E5	<u>Type</u>	<u>Days on Site: 365</u>	<u>Temperature</u>						
		Mixture		Ambient						
DOT: 5.1 - Oxidizing Substances Oxidizing Gas, Gaseous	<b>OXYGEN</b>	<b>Cu. Feet</b>	<b>256</b>	<b>256</b>	<b>256</b>		- Physical Gas Under Pressure - Physical Oxidizer	Oxygen, Compressed	100%	7782447
	<u>CAS No</u>	<u>State</u>	<u>Storage Container</u>	<u>Pressue</u>	<u>Waste Code</u>					
	7782447	Gas	Cylinder	> Ambient						
	Map: 1400 Grid: G6	<u>Type</u>	<u>Days on Site: 365</u>	<u>Temperature</u>						
		Pure		Ambient						
DOT: 2.2 - Nonflammable Gases Oxidizing Gas, Gaseous	<b>NITROUS OXIDE</b>	<b>Cu. Feet</b>	<b>197</b>	<b>197</b>	<b>197</b>		- Physical Gas Under Pressure - Physical Oxidizer	Nitrous Oxide	100%	10024972
	<u>CAS No</u>	<u>State</u>	<u>Storage Container</u>	<u>Pressue</u>	<u>Waste Code</u>					
	10024972	Liquid	Cylinder	> Ambient						
	Map: 1400 Grid: G6	<u>Type</u>	<u>Days on Site: 365</u>	<u>Temperature</u>						
		Pure		Ambient						
DOT: 2.2 - Nonflammable Gases	<b>NITROGEN</b>	<b>Cu. Feet</b>	<b>197</b>	<b>197</b>	<b>197</b>		- Physical Gas Under Pressure - Health Simple Asphyxiant	Nitrogen	100%	7727379
	<u>CAS No</u>	<u>State</u>	<u>Storage Container</u>	<u>Pressue</u>	<u>Waste Code</u>					
	7727379	Gas	Cylinder	> Ambient						
	Map: 1400 Grid: G6	<u>Type</u>	<u>Days on Site: 365</u>	<u>Temperature</u>						
		Pure		Ambient						
DOT: 2.1 - Flammable Gases Flammable Gas	<b>HYDROGEN</b>	<b>Cu. Feet</b>	<b>217</b>	<b>217</b>	<b>217</b>		- Physical Flammable - Physical Gas Under Pressure - Health Simple Asphyxiant	Hydrogen	100%	1333740
	<u>CAS No</u>	<u>State</u>	<u>Storage Container</u>	<u>Pressue</u>	<u>Waste Code</u>					
	1333740	Gas	Cylinder	> Ambient						
	Map: 1400 Grid: G6	<u>Type</u>	<u>Days on Site: 365</u>	<u>Temperature</u>						
		Pure		Ambient						
DOT: 2.2 - Nonflammable Gases	<b>HELIUM</b>	<b>Cu. Feet</b>	<b>291</b>	<b>291</b>	<b>291</b>		- Physical Gas Under Pressure - Health Simple Asphyxiant	Helium	100%	7440597
	<u>CAS No</u>	<u>State</u>	<u>Storage Container</u>	<u>Pressue</u>	<u>Waste Code</u>					
	7440597	Gas	Cylinder	> Ambient						
	Map: 1400 Grid: G6	<u>Type</u>	<u>Days on Site: 365</u>	<u>Temperature</u>						
		Pure		Ambient						
DOT: 2.2 - Nonflammable Gases	<b>CARBON DIOXIDE</b>	<b>Cu. Feet</b>	<b>197</b>	<b>197</b>	<b>197</b>		- Physical Gas Under Pressure - Health Simple Asphyxiant	Carbon Dioxide	100%	124389
	<u>CAS No</u>	<u>State</u>	<u>Storage Container</u>	<u>Pressue</u>	<u>Waste Code</u>					
	124-38-9	Gas	Cylinder	> Ambient						
	Map: 1400 Grid: G6	<u>Type</u>	<u>Days on Site: 365</u>	<u>Temperature</u>						
		Pure		Ambient						
DOT: 2.1 - Flammable Gases Unstable (Reactive), Class 2, Flammable Gas	<b>ACETYLENE</b>	<b>Cu. Feet</b>	<b>160</b>	<b>160</b>	<b>160</b>		- Physical Flammable - Physical Gas Under Pressure - Health Simple Asphyxiant	Acetylene	100%	74862
	<u>CAS No</u>	<u>State</u>	<u>Storage Container</u>	<u>Pressue</u>	<u>Waste Code</u>					
	74862	Gas	Cylinder	> Ambient						
	Map: 1400 Grid: G6	<u>Type</u>	<u>Days on Site: 365</u>	<u>Temperature</u>						
		Pure		Ambient						

## Hazardous Materials And Wastes Inventory Matrix Report

CERS Business/Org. <b>Shasta Tehama Trinity Joint Community College</b>	Chemical Location <b>BLDG 1600</b>	CERS ID <b>10490839</b>
Facility Name <b>Shasta Tehama Trinity Joint Community College</b> 11555 Old Oregon Trail, Redding 96003		Facility ID <b>45-000-000858</b>
		Status <b>Submitted on 3/4/2026 4:23 PM</b>

DOT Code/Fire Haz. Class	Common Name	Unit	Quantities			Annual Waste Amount	Federal Hazard Categories	Hazardous Components (For mixture only)		
			Max. Daily	Largest Cont.	Avg. Daily			Component Name	% Wt	EHS CAS No.
Combustible Liquid, Class III-B	<b>WASTE STORAGE SOLUTION WITH</b>	<b>Gallons</b>	<b>55</b>	<b>55</b>	<b>0</b>	<b>55</b>	- Health	PROPYLENE GLYCOL		57556
	<b>LAB SPECIMENS</b>	<u>State</u>	<u>Storage Container</u>		<u>Pressure</u>	<u>Waste Code</u>	Carcinogenicity	2-PHENOXYETHANOL		122996
		Liquid	Plastic/Non-metalic Drum		Ambient	551	- Health Acute	2-AMINO-2-ETHYL-1,3-PROPANEDIOL		115708
		<u>CAS No</u>	<u>Type</u>		<u>Temperature</u>		Toxicity			
	Map: MAP 1600 Grid: E9	Waste	Days on Site: 365		Ambient		- Health Skin			
							Corrosion			
							Irritation			

## Hazardous Materials And Wastes Inventory Matrix Report

CERS Business/Org. <b>Shasta Tehama Trinity Joint Community College</b> Facility Name <b>Shasta Tehama Trinity Joint Community College</b> 11555 Old Oregon Trail, Redding 96003	Chemical Location <b>BLDG 1800</b>	CERS ID <b>10490839</b> Facility ID <b>45-000-000858</b> Status <b>Submitted on 3/4/2026 4:23 PM</b>
--	---------------------------------------	--

DOT Code/Fire Haz. Class	Common Name	Unit	Quantities			Annual Waste Amount	Federal Hazard Categories	Hazardous Components (For mixture only)		
			Max. Daily	Largest Cont.	Avg. Daily			Component Name	% Wt	EHS CAS No.
DOT: 2.2 - Nonflammable Gases	<b>CARBON DIOXIDE</b>	<b>Gallons</b>	<b>88.5</b>	<b>88.5</b>	<b>50</b>		- Physical Gas Under Pressure	Carbon Dioxide	100%	124389
	<u>CAS No</u> 124-38-9 Map: 1800 Grid: H5	<u>State</u> Liquid <u>Type</u> Pure	<u>Storage Container</u> Aboveground Tank		<u>Pressue</u> > Ambient <u>Temperature</u> < Ambient	<u>Waste Code</u>	- Health Simple Asphyxiant			
DOT: 5.1 - Oxidizing Substances Oxidizing, Class 3, Water Reactive, Class 1, Corrosive, Unstable (Reactive), Class 1	<b>PULSAR PLUS CALCIUM HYPOCHLORITE BRIQUETTES</b>	<b>Pounds</b>	<b>500</b>	<b>50</b>	<b>300</b>		- Physical Oxidizer - Health Acute - Health Skin Corrosion Irritation - Health Serious Eye Damage Eye Irritation - Health Specific Target Organ Toxicity	Calcium Hypochlorite Sodium Chloride Calcium Chlorate Calcium Chloride Calcium Hydroxide	75% 15% 3% 3% 2%	7778-54-3 7647-14-5 10137-74-3 10043-52-4 1305-62-0
	<u>CAS No</u> 64742-53-6 Map: 1800 Grid: H5	<u>State</u> Solid <u>Type</u> Mixture	<u>Storage Container</u> Plastic/Non-metalic Drum	Days on Site: 365	<u>Pressue</u> Ambient <u>Temperature</u> Ambient	<u>Waste Code</u>				
DOT: 3 - Flammable and Combustible Liquids	<b>TRANSFORMER OIL</b>	<b>Gallons</b>	<b>529</b>	<b>529</b>	<b>529</b>		- Health Aspiration Hazard	Mineral Oil	100%	8020835
	<u>CAS No</u> 64742-53-6 Map: 1 Grid: E4	<u>State</u> Liquid <u>Type</u> Mixture	<u>Storage Container</u> Other	Days on Site: 365	<u>Pressue</u> Ambient <u>Temperature</u> Ambient	<u>Waste Code</u>				

## Hazardous Materials And Wastes Inventory Matrix Report

CERS Business/Org. <b>Shasta Tehama Trinity Joint Community College</b>	Chemical Location <b>BLDG 2000</b>	CERS ID <b>10490839</b>
Facility Name <b>Shasta Tehama Trinity Joint Community College</b> 11555 Old Oregon Trail, Redding 96003		Facility ID <b>45-000-000858</b>
		Status <b>Submitted on 3/4/2026 4:23 PM</b>

DOT Code/Fire Haz. Class	Common Name	Unit	Quantities			Annual Waste Amount	Federal Hazard Categories	Hazardous Components (For mixture only)		
			Max. Daily	Largest Cont.	Avg. Daily			Component Name	% Wt	EHS CAS No.
DOT: 2.2 - Nonflammable Gases	<b>Carbon Dioxide</b>	<b>Cu. Feet</b>	<b>700</b>	<b>175</b>	<b>500</b>		- Physical Gas Under Pressure - Health Simple Asphyxiant			
	<u>CAS No</u> 124-38-9	<u>State</u> Gas	<u>Storage Container</u> Cylinder		<u>Pressue</u> > Ambient	<u>Waste Code</u>				
		<u>Type</u> Pure			<u>Temperature</u> Ambient					

## Hazardous Materials And Wastes Inventory Matrix Report

CERS Business/Org. <b>Shasta Tehama Trinity Joint Community College</b>	Chemical Location <b>BLDG 2000, OUTSIDE</b>	CERS ID <b>10490839</b>
Facility Name <b>Shasta Tehama Trinity Joint Community College</b> 11555 Old Oregon Trail, Redding 96003		Facility ID <b>45-000-000858</b>
		Status <b>Submitted on 3/4/2026 4:23 PM</b>

DOT Code/Fire Haz. Class	Common Name	Unit	Quantities			Annual Waste Amount	Federal Hazard Categories	Hazardous Components (For mixture only)		
			Max. Daily	Largest Cont.	Avg. Daily			Component Name	% Wt	EHS CAS No.
Combustible Liquid, Class III-B	<b>TRANSFORMER OIL</b>	<b>Gallons</b>	<b>205</b>	<b>205</b>	205		- Health	Mineral Oil	100%	8020835
	<u>CAS No</u>	<u>State</u>	<u>Storage Container</u>		<u>Pressure</u>	<u>Waste Code</u>	Aspiration Hazard			
	64742-53-6	Liquid	Other		Ambient					
	Map: 1 Grid: D5	<u>Type</u>			<u>Temperature</u>					
		Mixture	Days on Site: 365		Ambient					
DOT: 3 - Flammable and Combustible Liquids	<b>DIESEL #2</b>	<b>Gallons</b>	<b>190</b>	<b>190</b>	190		- Physical	Diesel Fuel No. 2	100%	68476302
	<u>CAS No</u>	<u>State</u>	<u>Storage Container</u>		<u>Pressure</u>	<u>Waste Code</u>	Flammable			
	68476302	Liquid	Other		Ambient		- Health			
	Map: 1 Grid: D5	<u>Type</u>			<u>Temperature</u>		Carcinogenicity			
Combustible Liquid, Class II		Mixture	Days on Site: 365		Ambient		- Health Acute			
							Toxicity			
							- Health Skin			
							Corrosion			
							Irritation			
							- Health Specific			
							Target Organ			
							Toxicity			
							- Health			
							Aspiration Hazard			

## Hazardous Materials And Wastes Inventory Matrix Report

CERS Business/Org. <b>Shasta Tehama Trinity Joint Community College</b> Facility Name <b>Shasta Tehama Trinity Joint Community College</b> 11555 Old Oregon Trail, Redding 96003	Chemical Location <b>BLDG 2400</b>	CERS ID <b>10490839</b> Facility ID <b>45-000-000858</b> Status <b>Submitted on 3/4/2026 4:23 PM</b>
--	---------------------------------------	--

DOT Code/Fire Haz. Class	Common Name	Unit	Quantities			Annual Waste Amount	Federal Hazard Categories	Hazardous Components (For mixture only)		
			Max. Daily	Largest Cont.	Avg. Daily			Component Name	% Wt	EHS CAS No.
DOT: 2.2 - Nonflammable Gases	<b>NITROGEN</b>	<b>Cu. Feet</b>	<b>228</b>	<b>228</b>	<b>166</b>		- Physical Gas	Nitrogen	100%	7727379
	<u>CAS No</u>	<u>State</u>	<u>Storage Container</u>		<u>Pressue</u>	<u>Waste Code</u>	Under Pressure			
	7727379	Gas	Cylinder		> Ambient		- Health Simple			
	Map: 2400 Grid: B4	<u>Type</u>			<u>Temperature</u>		Asphyxiant			
		Pure	Days on Site: 365		Ambient					
	<b>AIR - COMPRESSED</b>	<b>Cu. Feet</b>	<b>288</b>	<b>144</b>	<b>210</b>		- Physical Gas			
	<u>CAS No</u>	<u>State</u>	<u>Storage Container</u>		<u>Pressue</u>	<u>Waste Code</u>	Under Pressure			
		Gas	Cylinder		> Ambient					
	Map: 2400 Grid: B4	<u>Type</u>			<u>Temperature</u>					
		Mixture	Days on Site: 365		Ambient					
	<b>OIL EATER CLEANER/DEGREASER</b>	<b>Gallons</b>	<b>90</b>	<b>45</b>	<b>75</b>		- Health Skin	Sodium Metasilicate Pentahydrate	5%	6834920
	<u>CAS No</u>	<u>State</u>	<u>Storage Container</u>		<u>Pressue</u>	<u>Waste Code</u>	Corrosion	2-Butoxyethanol	5%	111762
		Liquid	Plastic/Non-metalic Drum		Ambient		Irritation			
	Map: 2400 Grid: B6	<u>Type</u>			<u>Temperature</u>		- Health Serious			
		Mixture	Days on Site: 365		Ambient		Eye Damage Eye Irritation			
DOT: 3 - Flammable and Combustible Liquids	<b>Motor Oil/Hydraulic Oil/Gear Oil</b>	<b>Gallons</b>	<b>120</b>	<b>55</b>	<b>120</b>		- Physical Flammable	Lubricating Oil (Petroleum-based)	100%	8020835
	<u>CAS No</u>	<u>State</u>	<u>Storage Container</u>		<u>Pressue</u>	<u>Waste Code</u>				
	64742547	Liquid	Other		Ambient					
	Map: 2400 Grid: C4	<u>Type</u>			<u>Temperature</u>					
		Mixture	Days on Site: 365		Ambient					
DOT: 2.1 - Flammable Gases	<b>ACETYLENE</b>	<b>Cu. Feet</b>	<b>440</b>	<b>440</b>	<b>250</b>		- Physical Flammable	Acetylene	100%	74862
	<u>CAS No</u>	<u>State</u>	<u>Storage Container</u>		<u>Pressue</u>	<u>Waste Code</u>				
	74862	Gas	Cylinder		> Ambient		- Physical Gas			
	Map: 2400 Grid: B3	<u>Type</u>			<u>Temperature</u>		Under Pressure			
		Pure	Days on Site: 365		Ambient		- Health Simple			
							Asphyxiant			
DOT: 5.1 - Oxidizing Substances	<b>OXYGEN</b>	<b>Cu. Feet</b>	<b>281</b>	<b>281</b>	<b>170</b>		- Physical Gas	Oxygen, Compressed	100%	7782447
	<u>CAS No</u>	<u>State</u>	<u>Storage Container</u>		<u>Pressue</u>	<u>Waste Code</u>	Under Pressure			
	7782447	Gas	Cylinder		> Ambient		- Physical Oxidizer			
	Map: 2400 Grid: B3	<u>Type</u>			<u>Temperature</u>					
		Pure	Days on Site: 365		Ambient					
DOT: 9 - Misc. Hazardous Materials	<b>WASTE ANTI-FREEZE</b>	<b>Gallons</b>	<b>55</b>	<b>55</b>	<b>25</b>	<b>105</b>	- Health Acute Toxicity	ETHYLENE GLYCOL	50%	107-21-1
	<u>CAS No</u>	<u>State</u>	<u>Storage Container</u>		<u>Pressue</u>	<u>Waste Code</u>				
	107-21-1	Liquid	Steel Drum		Ambient		- Health Reproductive Toxicity			
	Map: 2400 Grid: C7	<u>Type</u>			<u>Temperature</u>	<b>133</b>	- Health Specific Target Organ Toxicity			
		Waste	Days on Site: 365		Ambient					

## Hazardous Materials And Wastes Inventory Matrix Report

CERS Business/Org. <b>Shasta Tehama Trinity Joint Community College</b>	Chemical Location <b>BLDG 2400, OUTSIDE</b>	CERS ID <b>10490839</b>
Facility Name <b>Shasta Tehama Trinity Joint Community College</b> 11555 Old Oregon Trail, Redding 96003		Facility ID <b>45-000-000858</b>
		Status <b>Submitted on 3/4/2026 4:23 PM</b>

DOT Code/Fire Haz. Class	Common Name	Unit	Quantities			Annual Waste Amount	Federal Hazard Categories	Hazardous Components (For mixture only)		
			Max. Daily	Largest Cont.	Avg. Daily			Component Name	% Wt	EHS CAS No.
DOT: 8 - Corrosives (Liquids and Solids)	<b>ENVIRO BLASTER</b>	<b>Gallons</b>	<b>55</b>	<b>55</b>	<b>35</b>		- Physical	Sodium Hydroxide, Solution	4%	1310732
Corrosive	CAS No Map: 2400 Grid: C1	State Liquid	Storage Container Plastic/Non-metalic Drum	Pressue Ambient	Temperature Ambient	Waste Code	Corrosive To Metal	ETHYLENEDIAMINE TETRAACETATE2%		64-02-8
		Type Mixture	Days on Site: 365				- Health Acute Toxicity - Health Skin Corrosion Irritation			
DOT: 3 - Flammable and Combustible Liquids	<b>MISCELLANEOUS PAINT/STAIN</b>	<b>Gallons</b>	<b>85</b>	<b>5</b>	<b>70</b>		- Physical	Acetone		67641
Flammable Liquid, Class I-A	CAS No Map: 2400 Grid: C2	State Liquid	Storage Container Plastic/Non-metalic Drum, Can	Pressue Ambient	Temperature Ambient	Waste Code	Flammable - Health	Stoddard Solvent		8030306
		Type Mixture	Days on Site: 365				Carcinogenicity - Health Reproductive Toxicity - Health Respiratory Skin Sensitization - Health Serious Eye Damage Eye Irritation - Health Specific Target Organ Toxicity - Health Aspiration Hazard - Health Germ Cell Mutagenicity	Hydrotreated Light Distillate Hydrotreated heavy naphtha, petroleum Methanol		64742478 64742489 67561

## Hazardous Materials And Wastes Inventory Matrix Report

CERS Business/Org. <b>Shasta Tehama Trinity Joint Community College</b>	Chemical Location <b>BLDG 2400, OUTSIDE</b>	CERS ID <b>10490839</b>
Facility Name <b>Shasta Tehama Trinity Joint Community College</b> 11555 Old Oregon Trail, Redding 96003		Facility ID <b>45-000-000858</b>
		Status <b>Submitted on 3/4/2026 4:23 PM</b>

DOT Code/Fire Haz. Class	Common Name	Unit	Quantities			Annual Waste Amount	Federal Hazard Categories	Hazardous Components (For mixture only)		
			Max. Daily	Largest Cont.	Avg. Daily			Component Name	% Wt	EHS CAS No.
DOT: 3 - Flammable and Combustible Liquids	<b>WASTE OIL</b>	<b>Gallons</b>	<b>500</b>	<b>500</b>	200	290	- Physical Flammable	Waste Oil, Petroleum Based	100%	0
Combustible Liquid, Class III-B	CAS No Map: 2400 Grid: A6	State Liquid Type Waste	Storage Container Belowground Tank		Pressue Ambient Temperature Ambient	Waste Code 221	- Health Carcinogenicity - Health Acute Toxicity - Health Reproductive Toxicity - Health Skin Corrosion Irritation - Health Respiratory Skin Sensitization - Health Serious Eye Damage Eye Irritation - Health Specific Target Organ Toxicity - Health Aspiration Hazard			
DOT: 8 - Corrosives (Liquids and Solids)	<b>ZEP RECIRCULATING DETERGENT</b>	<b>Gallons</b>	<b>60</b>	<b>60</b>	53		- Health Acute Toxicity	Sodium Metasilicate	35%	6834920
Corrosive	CAS No Map: 2400 Grid: D9	State Liquid Type Mixture	Storage Container Other		Pressue Ambient Temperature Ambient	Waste Code	- Health Skin Corrosion Irritation - Health Serious Eye Damage Eye Irritation - Health Specific Target Organ Toxicity	Sodium Carbonate	35%	497198
	<b>WASTE DIRT WITH OIL</b>	<b>Pounds</b>	<b>600</b>	<b>600</b>	100	1000		VARIOUS LUBRICATING OILS	5%	6474X-XX-X
	CAS No Map: 2400 Grid: C2	State Solid Type Waste	Storage Container Steel Drum		Pressue Ambient Temperature Ambient	Waste Code 223				
DOT: 3 - Flammable and Combustible Liquids	<b>TRANSFORMER OIL</b>	<b>Gallons</b>	<b>309</b>	<b>309</b>	309			Mineral Oil	100%	8020835
Combustible Liquid, Class III-B	CAS No 64742-53-6 Map: 1 Grid: F5	State Liquid Type Mixture	Storage Container Other		Pressue Ambient Temperature Ambient	Waste Code				

## Hazardous Materials And Wastes Inventory Matrix Report

CERS Business/Org. <b>Shasta Tehama Trinity Joint Community College</b>	Chemical Location <b>BLDG 2500</b>	CERS ID <b>10490839</b>
Facility Name <b>Shasta Tehama Trinity Joint Community College</b> 11555 Old Oregon Trail, Redding 96003		Facility ID <b>45-000-000858</b>
		Status <b>Submitted on 3/4/2026 4:23 PM</b>

DOT Code/Fire Haz. Class	Common Name	Unit	Quantities			Annual Waste Amount	Federal Hazard Categories	Hazardous Components (For mixture only)		
			Max. Daily	Largest Cont.	Avg. Daily			Component Name	% Wt	EHS CAS No.
DOT: 3 - Flammable and Combustible Liquids Combustible Liquid, Class III-B	<b>Motor Oil/Hydraulic Oil/Gear Oil</b>  CAS No. 64742547 Map: 2500	<b>Gallons</b> State Liquid Type Mixture	<b>440</b> Storage Container Steel Drum Days on Site: 365	<b>55</b>	320 Pressue Ambient Temperature Ambient		- Physical Flammable	Lubricating Oil (Petroleum-Based)	100%	8020835
DOT: 2.1 - Flammable Gases Unstable (Reactive), Class 2, Flammable Gas	<b>ACETYLENE</b>  CAS No. 74862 Map: 2500 Grid: H3	<b>Cu. Feet</b> State Gas Type Pure	<b>440</b> Storage Container Cylinder Days on Site: 365	<b>440</b>	264 Pressue > Ambient Temperature Ambient		- Physical Flammable - Physical Gas Under Pressure - Health Simple Asphyxiant	Acetylene	100%	74862
DOT: 5.1 - Oxidizing Substances Oxidizing Gas, Gaseous	<b>OXYGEN</b>  CAS No. 7782447 Map: 2500 Grid: H3	<b>Cu. Feet</b> State Gas Type Pure	<b>502</b> Storage Container Cylinder Days on Site: 365	<b>251</b>	302 Pressue > Ambient Temperature Ambient		- Physical Gas Under Pressure - Physical Oxidizer	Oxygen, Compressed	100%	7782447
DOT: 2.2 - Nonflammable Gases	<b>ARGON</b>  CAS No. 7440371 Map: 2500 Grid: H3	<b>Cu. Feet</b> State Gas Type Pure	<b>562</b> Storage Container Cylinder Days on Site: 365	<b>281</b>	338 Pressue > Ambient Temperature Ambient		- Physical Gas Under Pressure - Health Simple Asphyxiant	Argon	100%	7440371
DOT: 3 - Flammable and Combustible Liquids Combustible Liquid, Class II	<b>DIESEL #2</b>  CAS No. 68476302 Map: 2500 Grid: F5	<b>Gallons</b> State Liquid Type Mixture	<b>30</b> Storage Container Tank Wagon Days on Site: 365	<b>30</b>	5 Pressue Ambient Temperature Ambient		- Physical Flammable - Health Carcinogenicity - Health Acute Toxicity - Health Skin Corrosion Irritation - Health Specific Target Organ Toxicity - Health Aspiration Hazard	Diesel Fuel No. 2	100%	68476302
	<b>OIL EATER CLEANER/DEGREASER</b>  CAS No. Map: 2500 Grid: F4	<b>Gallons</b> State Liquid Type Mixture	<b>120</b> Storage Container Plastic/Non-metalic Drum Days on Site: 365	<b>45</b>	115 Pressue Ambient Temperature Ambient		- Health Skin Corrosion Irritation - Health Serious Eye Damage Eye Irritation	Sodium Metasilicate Pentahydrate 2-Butoxyethanol	5% 5%	6834920 111762

## Hazardous Materials And Wastes Inventory Matrix Report

CERS Business/Org. <b>Shasta Tehama Trinity Joint Community College</b>	Chemical Location <b>BLDG 2500</b>	CERS ID <b>10490839</b>
Facility Name <b>Shasta Tehama Trinity Joint Community College</b> 11555 Old Oregon Trail, Redding 96003		Facility ID <b>45-000-000858</b>
		Status <b>Submitted on 3/4/2026 4:23 PM</b>

DOT Code/Fire Haz. Class	Common Name	Unit	Quantities			Annual Waste Amount	Federal Hazard Categories	Hazardous Components (For mixture only)		
			Max. Daily	Largest Cont.	Avg. Daily			Component Name	% Wt	EHS CAS No.
DOT: 2.2 - Nonflammable Gases	<b>ARGON/CARBON DIOXIDE</b>	<b>Cu. Feet</b>	<b>550</b>	<b>380</b>	<b>400</b>		- Physical Gas	Argon	75%	7440371
	<u>CAS No</u>	<u>State</u>	<u>Storage Container</u>		<u>Pressue</u>	<u>Waste Code</u>	Under Pressure	Carbon Dioxide	25%	124389
	Map: 2500 Grid: D5	<u>Gas</u>	Cylinder		> Ambient		- Health Simple			
		<u>Type</u>			<u>Temperature</u>		Asphyxiant			
		<u>Mixture</u>	Days on Site: 365		Ambient					

## Hazardous Materials And Wastes Inventory Matrix Report

CERS Business/Org. <b>Shasta Tehama Trinity Joint Community College</b> Facility Name <b>Shasta Tehama Trinity Joint Community College</b> 11555 Old Oregon Trail, Redding 96003	Chemical Location <b>BLDG 2500, OUTSIDE</b>	CERS ID <b>10490839</b> Facility ID <b>45-000-000858</b> Status <b>Submitted on 3/4/2026 4:23 PM</b>
--	--	--

DOT Code/Fire Haz. Class	Common Name	Unit	Quantities			Annual Waste Amount	Federal Hazard Categories	Hazardous Components (For mixture only)		
			Max. Daily	Largest Cont.	Avg. Daily			Component Name	% Wt	EHS CAS No.
DOT: 2.1 - Flammable Gases	<b>ACETYLENE</b>	<b>Cu. Feet</b>	<b>4544</b>	<b>440</b>	2690		- Physical	Acetylene	100%	74862
Unstable (Reactive), Class 2, Flammable Gas	CAS No 74862 Map: 2500 Grid: J2	State Gas Type Pure	Storage Container Cylinder Days on Site: 365		Pressue > Ambient Temperature Ambient	Waste Code	Flammable - Physical Gas Under Pressure - Health Simple Asphyxiant			
DOT: 2.2 - Nonflammable Gases	<b>ARGON</b>	<b>Cu. Feet</b>	<b>4686</b>	<b>336</b>	2810		- Physical Gas Under Pressure	Argon	100%	7440371
	CAS No 7440371 Map: 2500 Grid: J2	State Gas Type Pure	Storage Container Cylinder Days on Site: 365		Pressue > Ambient Temperature Ambient	Waste Code	- Health Simple Asphyxiant			
DOT: 2.2 - Nonflammable Gases	<b>CARBON DIOXIDE</b>	<b>Cu. Feet</b>	<b>4360</b>	<b>436</b>	2616		- Physical Gas Under Pressure	Carbon Dioxide	100%	124389
	CAS No 124-38-9 Map: 2500 Grid: J2	State Gas Type Pure	Storage Container Cylinder Days on Site: 365		Pressue > Ambient Temperature Ambient	Waste Code	- Health Simple Asphyxiant			
DOT: 5.1 - Oxidizing Substances	<b>OXYGEN</b>	<b>Cu. Feet</b>	<b>4550</b>	<b>281</b>	2870		- Physical Gas Under Pressure	Oxygen, Compressed	100%	7782447
Oxidizing Gas, Gaseous	CAS No 7782447 Map: 2500 Grid: J2	State Gas Type Pure	Storage Container Cylinder Days on Site: 365		Pressue > Ambient Temperature Ambient	Waste Code	- Physical Oxidizer			
DOT: 2.1 - Flammable Gases	<b>PROPANE</b>	<b>Gallons</b>	<b>100</b>	<b>24</b>	62		- Physical Flammable	Propane	100%	74986
Flammable Gas	CAS No 74986 Map: 2500 Grid: J2	State Gas Type Pure	Storage Container Cylinder Days on Site: 365		Pressue > Ambient Temperature Ambient	Waste Code	- Physical Gas Under Pressure - Health Simple Asphyxiant			
DOT: 2.2 - Nonflammable Gases	<b>ARGON/CARBON DIOXIDE</b>	<b>Cu. Feet</b>	<b>3176</b>	<b>296</b>	1904		- Physical Gas Under Pressure	Argon Carbon Dioxide	75% 25%	7440371 124389
	CAS No Map: 2500 Grid: J2	State Gas Type Mixture	Storage Container Cylinder Days on Site: 365		Pressue > Ambient Temperature Ambient	Waste Code	- Health Simple Asphyxiant			
	<b>TRANSFORMER OIL</b>	<b>Gallons</b>	<b>160</b>	<b>160</b>	160		- Health Aspiration Hazard	Mineral Oil	100%	8020835
Combustible Liquid, Class III-B	CAS No 64742-53-6 Map: 1 Grid: G5	State Liquid Type Mixture	Storage Container Other Days on Site: 365		Pressue Ambient Temperature Ambient	Waste Code				

## Hazardous Materials And Wastes Inventory Matrix Report

CERS Business/Org. <b>Shasta Tehama Trinity Joint Community College</b>	Chemical Location <b>BLDG 2500, OUTSIDE</b>	CERS ID <b>10490839</b>
Facility Name <b>Shasta Tehama Trinity Joint Community College</b> 11555 Old Oregon Trail, Redding 96003		Facility ID <b>45-000-000858</b>
		Status <b>Submitted on 3/4/2026 4:23 PM</b>

DOT Code/Fire Haz. Class	Common Name	Unit	Quantities			Annual Waste Amount	Federal Hazard Categories	Hazardous Components (For mixture only)		
			Max. Daily	Largest Cont.	Avg. Daily			Component Name	% Wt	EHS CAS No.
DOT: 3 - Flammable and Combustible Liquids	<b>WASTE OIL</b>	<b>Gallons</b>	<b>500</b>	<b>500</b>	200	5	- Physical - Flammable	Waste Oil, Petroleum Based	100%	0
Combustible Liquid, Class III-B	CAS No Map: 2500 Grid: H3	State Liquid Type Waste	Storage Container Belowground Tank		Pressue Ambient Temperature Ambient	Waste Code 221	- Health - Health Acute Toxicity - Health Reproductive Toxicity - Health Skin Corrosion Irritation - Health Respiratory Skin Sensitization - Health Serious Eye Damage Eye Irritation - Health Specific Target Organ Toxicity - Health Aspiration Hazard			
DOT: 8 - Corrosives (Liquids and Solids)	<b>GOODSON PJS-50 Pro JET SPRAY</b>	<b>Gallons</b>	<b>270</b>	<b>270</b>	250		- Health Skin Corrosion	Trade Secret		
Corrosive	CAS No Map: 2500 Grid: D3	State Liquid Type Mixture	Storage Container Aboveground Tank		Pressue Ambient Temperature Ambient	Waste Code	Irritation - Health Serious Eye Damage Eye Irritation			

## Hazardous Materials And Wastes Inventory Matrix Report

CERS Business/Org. <b>Shasta Tehama Trinity Joint Community College</b>	Chemical Location <b>BLDG 2600</b>	CERS ID <b>10490839</b>
Facility Name <b>Shasta Tehama Trinity Joint Community College</b> 11555 Old Oregon Trail, Redding 96003		Facility ID <b>45-000-000858</b>
		Status <b>Submitted on 3/4/2026 4:23 PM</b>

DOT Code/Fire Haz. Class	Common Name	Unit	Quantities			Annual Waste Amount	Federal Hazard Categories	Hazardous Components (For mixture only)		
			Max. Daily	Largest Cont.	Avg. Daily			Component Name	% Wt	EHS CAS No.
DOT: 2.2 - Nonflammable Gases	<b>ARGON</b>	<b>Cu. Feet</b>	<b>1090</b>	<b>281</b>	650		- Physical Gas Under Pressure - Health Simple Asphyxiant	Argon	100%	7440371
	<u>CAS No</u> 7440371 Map: 2600 Grid: G7	<u>State</u> Gas <u>Type</u> Pure	<u>Storage Container</u> Cylinder Days on Site: 365		<u>Pressue</u> > Ambient <u>Temperature</u> Ambient	<u>Waste Code</u>				
DOT: 2.1 - Flammable Gases Unstable (Reactive), Class 2, Flammable Gas	<b>ACETYLENE</b>	<b>Cu. Feet</b>	<b>1320</b>	<b>440</b>	792		- Physical Flammable - Physical Gas Under Pressure - Health Simple Asphyxiant	Acetylene	100%	74862
	<u>CAS No</u> 74862 Map: 2600 Grid: E7	<u>State</u> Gas <u>Type</u> Pure	<u>Storage Container</u> Cylinder Days on Site: 365		<u>Pressue</u> > Ambient <u>Temperature</u> Ambient	<u>Waste Code</u>				
DOT: 5.1 - Oxidizing Substances Oxidizing Gas, Gaseous	<b>OXYGEN</b>	<b>Cu. Feet</b>	<b>2130</b>	<b>281</b>	1200		- Physical Gas Under Pressure - Physical Oxidizer	Oxygen, Compressed	100%	7782447
	<u>CAS No</u> 7782447 Map: 2600 Grid: E7	<u>State</u> Gas <u>Type</u> Pure	<u>Storage Container</u> Cylinder Days on Site: 365		<u>Pressue</u> > Ambient <u>Temperature</u> Ambient	<u>Waste Code</u>				
DOT: 2.1 - Flammable Gases Flammable Gas	<b>PROPANE</b>	<b>Gallons</b>	<b>48</b>	<b>24</b>	30		- Physical Flammable - Physical Gas Under Pressure - Health Simple Asphyxiant	Propane	100%	74986
	<u>CAS No</u> 74986 Map: 2600 Grid: E7	<u>State</u> Gas <u>Type</u> Pure	<u>Storage Container</u> Cylinder Days on Site: 365		<u>Pressue</u> > Ambient <u>Temperature</u> Ambient	<u>Waste Code</u>				
DOT: 2.2 - Nonflammable Gases	<b>ARGON/CARBON DIOXIDE</b>	<b>Cu. Feet</b>	<b>1260</b>	<b>381</b>	620			Argon Carbon Dioxide	75% 25%	7440371 124389
	<u>CAS No</u> Map: 2600 Grid: G7	<u>State</u> Gas <u>Type</u> Mixture	<u>Storage Container</u> Cylinder Days on Site: 365		<u>Pressue</u> > Ambient <u>Temperature</u> Ambient	<u>Waste Code</u>				
DOT: 2.2 - Nonflammable Gases	<b>CARBON DIOXIDE</b>	<b>Cu. Feet</b>	<b>439</b>	<b>439</b>	270			Carbon Dioxide	100%	124389
	<u>CAS No</u> 124-38-9 Map: 2600 Grid: G7	<u>State</u> Gas <u>Type</u> Pure	<u>Storage Container</u> Cylinder Days on Site: 365		<u>Pressue</u> > Ambient <u>Temperature</u> Ambient	<u>Waste Code</u>				

## Hazardous Materials And Wastes Inventory Matrix Report

CERS Business/Org. <b>Shasta Tehama Trinity Joint Community College</b>	Chemical Location <b>BLDG 2600, OUTSIDE</b>	CERS ID <b>10490839</b>
Facility Name <b>Shasta Tehama Trinity Joint Community College</b> 11555 Old Oregon Trail, Redding 96003		Facility ID <b>45-000-000858</b>
		Status <b>Submitted on 3/4/2026 4:23 PM</b>

DOT Code/Fire Haz. Class	Common Name	Unit	Quantities			Annual Waste Amount	Federal Hazard Categories	Hazardous Components (For mixture only)		
			Max. Daily	Largest Cont.	Avg. Daily			Component Name	% Wt	EHS CAS No.
DOT: 2.1 - Flammable Gases	<b>PROPANE</b>	<b>Gallons</b>	<b>144</b>	<b>24</b>	<b>100</b>		- Physical	Propane	100%	74986
Flammable Gas	<u>CAS No</u> 74986 Map: 2600 Grid: C8	<u>State</u> Gas <u>Type</u> Pure	<u>Storage Container</u> Cylinder  Days on Site: 365		<u>Pressue</u> > Ambient <u>Temperature</u> Ambient	<u>Waste Code</u>	Flammable - Physical Gas Under Pressure - Health Simple Asphyxiant			
DOT: 5.1 - Oxidizing Substances	<b>OXYGEN</b>	<b>Cu. Feet</b>	<b>281</b>	<b>281</b>	<b>169</b>		- Physical Gas Under Pressure	Oxygen, Compressed	100%	7782447
Oxidizing Gas, Gaseous	<u>CAS No</u> 7782447 Map: 2600 Grid: C8	<u>State</u> Gas <u>Type</u> Pure	<u>Storage Container</u> Cylinder  Days on Site: 365		<u>Pressue</u> > Ambient <u>Temperature</u> Ambient	<u>Waste Code</u>	- Physical Oxidizer			
DOT: 2.2 - Nonflammable Gases	<b>CARBON DIOXIDE</b>	<b>Cu. Feet</b>	<b>1760</b>	<b>436</b>	<b>1047</b>		- Physical Gas Under Pressure	Carbon Dioxide	100%	124389
	<u>CAS No</u> 124-38-9 Map: 2600 Grid: C3	<u>State</u> Gas <u>Type</u> Pure	<u>Storage Container</u> Cylinder  Days on Site: 365		<u>Pressue</u> > Ambient <u>Temperature</u> Ambient	<u>Waste Code</u>	- Health Simple Asphyxiant			

## Hazardous Materials And Wastes Inventory Matrix Report

CERS Business/Org. <b>Shasta Tehama Trinity Joint Community College</b> Facility Name <b>Shasta Tehama Trinity Joint Community College</b> 11555 Old Oregon Trail, Redding 96003	Chemical Location <b>BLDG 2900</b>	CERS ID <b>10490839</b> Facility ID <b>45-000-000858</b> Status <b>Submitted on 3/4/2026 4:23 PM</b>
--	---------------------------------------	--

DOT Code/Fire Haz. Class	Common Name	Unit	Quantities			Annual Waste Amount	Federal Hazard Categories	Hazardous Components (For mixture only)		
			Max. Daily	Largest Cont.	Avg. Daily			Component Name	% Wt	EHS CAS No.
DOT: 2.1 - Flammable Gases	<b>ACETYLENE</b>	<b>Cu. Feet</b>	<b>880</b>	<b>440</b>	<b>528</b>		- Physical	Acetylene	100%	74862
Unstable (Reactive), Class 2, Flammable Gas	CAS No 74862 Map: 2900	State Gas Type Pure	Storage Container Cylinder Days on Site: 365		Pressue > Ambient Temperature Ambient	Waste Code	Flammable - Physical Gas Under Pressure - Health Simple Asphyxiant			
DOT: 5.1 - Oxidizing Substances	<b>OXYGEN</b>	<b>Cu. Feet</b>	<b>1690</b>	<b>281</b>	<b>980</b>		- Physical Gas	Oxygen, Compressed	100%	7782447
Oxidizing Gas, Gaseous	CAS No 7782447 Map: 2900	State Gas Type Pure	Storage Container Cylinder Days on Site: 365		Pressue > Ambient Temperature Ambient	Waste Code	Under Pressure - Physical Oxidizer			
DOT: 9 - Misc. Hazardous Materials	<b>ANTI FREEZE</b>	<b>Gallons</b>	<b>110</b>	<b>55</b>	<b>66</b>		- Health Acute Toxicity	Ethylene Glycol	95%	107211
Combustible Liquid, Class III-B	CAS No 107211 Map: 2900 Grid: C3	State Liquid Type Mixture	Storage Container Steel Drum Days on Site: 365		Pressue Ambient Temperature Ambient	Waste Code	- Health Reproductive Toxicity - Health Specific Target Organ Toxicity			
DOT: 2.2 - Nonflammable Gases	<b>ARGON/CARBON DIOXIDE</b>	<b>Cu. Feet</b>	<b>832</b>	<b>296</b>	<b>450</b>		- Physical Gas Under Pressure	Argon Carbon Dioxide	75% 25%	7440371 124389
	CAS No Map: 2900	State Gas Type Mixture	Storage Container Cylinder Days on Site: 365		Pressue > Ambient Temperature Ambient	Waste Code	- Health Simple Asphyxiant			
DOT: 8 - Corrosives (Liquids and Solids)	<b>MAGNUM 440 RTU</b>	<b>Gallons</b>	<b>55</b>	<b>55</b>	<b>33</b>		- Physical Corrosive To	Silicic acid, disodium salt	5%	6834920
Corrosive	CAS No Map: 2900 Grid: B3	State Liquid Type Mixture	Storage Container Plastic/Non-metalic Drum Days on Site: 365		Pressue Ambient Temperature Ambient	Waste Code	Metal - Health Carcinogenicity - Health Acute Toxicity - Health Skin Corrosion Irritation - Health Serious Eye Damage Eye Irritation	Ethylenediaminetetraacetic acid, sodium salt Glycene, N,N-bis (carboxymethyl) -	5% 5%	64028 139139
	<b>MISCELLANEOUS PAINT</b>	<b>Gallons</b>	<b>625</b>	<b>5</b>	<b>400</b>		- Health Carcinogenicity	Titanium Dioxide Silica, Crystalline		13463677 7631869
	CAS No Map: 2900 Grid: F3	State Liquid Type Mixture	Storage Container Plastic/Non-metalic Drum Days on Site: 365		Pressue Ambient Temperature Ambient	Waste Code	- Health Specific Target Organ Toxicity	NEPHELINE SYENITE Diatomaceous Earth		12736-96-8 6885549

## Hazardous Materials And Wastes Inventory Matrix Report

CERS Business/Org. <b>Shasta Tehama Trinity Joint Community College</b> Facility Name <b>Shasta Tehama Trinity Joint Community College</b> 11555 Old Oregon Trail, Redding 96003	Chemical Location <b>BLDG 2900</b>	CERS ID <b>10490839</b> Facility ID <b>45-000-000858</b> Status <b>Submitted on 3/4/2026 4:23 PM</b>
--	---------------------------------------	--

DOT Code/Fire Haz. Class	Common Name	Unit	Quantities			Annual Waste Amount	Federal Hazard Categories	Hazardous Components (For mixture only)		
			Max. Daily	Largest Cont.	Avg. Daily			Component Name	% Wt	EHS CAS No.
DOT: 3 - Flammable and Combustible Liquids Combustible Liquid, Class III-B	<b>Motor Oil/Hydraulic Oil/Gear Oil</b>	<b>Gallons</b>	<b>770</b>	<b>165</b>	<b>350</b>		- Physical Flammable	Lubricating Oil (Petroleum-Based)	100%	8020835
	<u>CAS No</u> 64742547 Map: 2900 Grid: B4	<u>State</u> Liquid <u>Type</u> Mixture	<u>Storage Container</u> Tank Inside Building, Steel Drum, Plastic/Non-metalic Drum Days on Site: 365	<u>Pressue</u> Ambient <u>Temperature</u> Ambient	<u>Waste Code</u>					
	<b>OIL EATER CLEANER/DEGREASER</b>	<b>Gallons</b>	<b>170</b>	<b>55</b>	<b>90</b>		- Health Skin Corrosion Irritation - Health Serious Eye Damage Eye Irritation	Sodium Metasilicate Pentahydrate 2-Butoxyethanol	5% 5%	6834920 111762
	<u>CAS No</u>  Map: 2900	<u>State</u> Liquid <u>Type</u> Mixture	<u>Storage Container</u> Plastic/Non-metalic Drum Days on Site: 365	<u>Pressue</u> Ambient <u>Temperature</u> Ambient	<u>Waste Code</u>					
	<b>SHINE AND SHIELD</b>	<b>Gallons</b>	<b>55</b>	<b>55</b>	<b>33</b>			Dimethyloctadecyl ammonium chloride Lauryldimethylamine oxide	10% 5%	27668526 1643205
	<u>CAS No</u>  Map: 2900 Grid: B3	<u>State</u> Liquid <u>Type</u> Mixture	<u>Storage Container</u> Plastic/Non-metalic Drum Days on Site: 365	<u>Pressue</u> Ambient <u>Temperature</u> Ambient	<u>Waste Code</u>					
DOT: 9 - Misc. Hazardous Materials Combustible Liquid, Class III-B	<b>WASTE ANTI-FREEZE</b>	<b>Gallons</b>	<b>55</b>	<b>55</b>	<b>5</b>	<b>60</b>	- Health Acute Toxicity - Health Reproductive Toxicity - Health Specific Target Organ Toxicity	Ethylene Glycol	50%	107211
	<u>CAS No</u> 107211 Map: 2900 Grid: C3	<u>State</u> Liquid <u>Type</u> Waste	<u>Storage Container</u> Steel Drum Days on Site: 365	<u>Pressue</u> Ambient <u>Temperature</u> Ambient	<u>Waste Code</u> 133					
DOT: 8 - Corrosives (Liquids and Solids) Corrosive	<b>CITREX 1500</b>	<b>Gallons</b>	<b>55</b>	<b>55</b>	<b>35</b>		- Physical Corrosive To Metal - Health Skin Corrosion Irritation - Health Serious Eye Damage Eye Irritation	Citric Acid Sulfamic Acid	10% 10%	77-92-9 5329-14-6
	<u>CAS No</u>  Map: 2900 Grid: B3	<u>State</u> Liquid <u>Type</u> Mixture	<u>Storage Container</u> Plastic/Non-metalic Drum Days on Site: 365	<u>Pressue</u> Ambient <u>Temperature</u> Ambient	<u>Waste Code</u>					

## Hazardous Materials And Wastes Inventory Matrix Report

CERS Business/Org. <b>Shasta Tehama Trinity Joint Community College</b> Facility Name <b>Shasta Tehama Trinity Joint Community College</b> 11555 Old Oregon Trail, Redding 96003	Chemical Location <b>BLDG 2900, OUTSIDE</b>	CERS ID <b>10490839</b> Facility ID <b>45-000-000858</b> Status <b>Submitted on 3/4/2026 4:23 PM</b>
--	--	--

DOT Code/Fire Haz. Class	Common Name	Unit	Quantities			Annual Waste Amount	Federal Hazard Categories	Hazardous Components (For mixture only)		
			Max. Daily	Largest Cont.	Avg. Daily			Component Name	% Wt	EHS CAS No.
DOT: 5.1 - Oxidizing Substances	<b>OXYGEN</b>	<b>Cu. Feet</b>	<b>562</b>	<b>281</b>	<b>338</b>		- Physical Gas Under Pressure	Oxygen, Compressed	100%	7782447
Oxidizing Gas, Gaseous	<u>CAS No</u> 7782447 Map: 2900 Grid: F2	<u>State</u> Gas <u>Type</u> Pure	<u>Storage Container</u> Cylinder Days on Site: 365		<u>Pressue</u> > Ambient <u>Temperature</u> Ambient	<u>Waste Code</u>	- Physical Oxidizer			
DOT: 3 - Flammable and Combustible Liquids	<b>DIESEL #2</b>	<b>Gallons</b>	<b>10000</b>	<b>10000</b>	<b>7500</b>		- Physical Flammable	Diesel Fuel No. 2	100%	68476302
Combustible Liquid, Class II	<u>CAS No</u> 68476302 Map: 2900 Grid: J5	<u>State</u> Liquid <u>Type</u> Mixture	<u>Storage Container</u> Belowground Tank Days on Site: 365		<u>Pressue</u> Ambient <u>Temperature</u> Ambient	<u>Waste Code</u>	- Health Carcinogenicity - Health Acute Toxicity - Health Skin Corrosion Irritation - Health Specific Target Organ Toxicity - Health Aspiration Hazard			
DOT: 3 - Flammable and Combustible Liquids	<b>GASOLINE</b>	<b>Gallons</b>	<b>10000</b>	<b>10000</b>	<b>7500</b>		- Physical Flammable	Gasoline	100%	8006619
Flammable Liquid, Class I-B	<u>CAS No</u> 8006619 Map: 2900 Grid: J5	<u>State</u> Liquid <u>Type</u> Mixture	<u>Storage Container</u> Belowground Tank Days on Site: 365		<u>Pressue</u> Ambient <u>Temperature</u> Ambient	<u>Waste Code</u>	- Health Carcinogenicity - Health Skin Corrosion Irritation - Health Specific Target Organ Toxicity - Health Aspiration Hazard - Health Germ Cell Mutagenicity			

## Hazardous Materials And Wastes Inventory Matrix Report

CERS Business/Org. <b>Shasta Tehama Trinity Joint Community College</b> Facility Name <b>Shasta Tehama Trinity Joint Community College</b> 11555 Old Oregon Trail, Redding 96003	Chemical Location <b>BLDG 2900, OUTSIDE</b>	CERS ID <b>10490839</b> Facility ID <b>45-000-000858</b> Status <b>Submitted on 3/4/2026 4:23 PM</b>
--	--	--

DOT Code/Fire Haz. Class	Common Name	Unit	Quantities			Annual Waste Amount	Federal Hazard Categories	Hazardous Components (For mixture only)		
			Max. Daily	Largest Cont.	Avg. Daily			Component Name	% Wt	EHS CAS No.
DOT: 3 - Flammable and Combustible Liquids	<b>WASTE OIL</b>	<b>Gallons</b>	<b>500</b>	<b>500</b>	200	415	- Physical Flammable	Waste Oil, Petroleum Based	100%	0
Combustible Liquid, Class III-B	CAS No	State	Storage Container		Pressue		- Health			
	Map: 2900 Grid: A4	Liquid	Belowground Tank		Ambient	221	Carcinogenicity			
		Type	Waste	Days on Site: 365	Ambient		- Health Acute Toxicity - Health Reproductive Toxicity - Health Skin Corrosion Irritation - Health Respiratory Skin Sensitization - Health Serious Eye Damage Eye Irritation - Health Specific Target Organ Toxicity - Health Aspiration Hazard			

## Hazardous Materials And Wastes Inventory Matrix Report

CERS Business/Org. <b>Shasta Tehama Trinity Joint Community College</b>	Chemical Location <b>BLDG 2950</b>	CERS ID <b>10490839</b>
Facility Name <b>Shasta Tehama Trinity Joint Community College</b> 11555 Old Oregon Trail, Redding 96003		Facility ID <b>45-000-000858</b>
		Status <b>Submitted on 3/4/2026 4:23 PM</b>

DOT Code/Fire Haz. Class	Common Name	Unit	Quantities			Annual Waste Amount	Federal Hazard Categories	Hazardous Components (For mixture only)		
			Max. Daily	Largest Cont.	Avg. Daily			Component Name	% Wt	EHS CAS No.
Combustible Liquid, Class III-B	<b>TRANSFORMER OIL</b>	<b>Gallons</b>	<b>110</b>	<b>55</b>	<b>110</b>		- Health Aspiration Hazard	Lubricating Oil (Petroleum-Based)	100%	8020835
	<u>CAS No</u> 64742-53-6	<u>State</u> Liquid	<u>Storage Container</u> Steel Drum			<u>Pressue</u> Ambient	<u>Waste Code</u>			
	Map: 2700 Grid: F2	<u>Type</u> Mixture	Days on Site: 365			<u>Temperature</u> Ambient				
	<b>Vital Oxide</b>	<b>Gallons</b>	<b>130</b>	<b>5</b>	<b>65</b>		- Health Serious Eye Damage Eye Irritation	n-Alkyl Dimethyl Benzyl Ammonium Chloride n-Alkyl Dimethyl Ethylbenzyl Ammonium Chloride	0% 0%	68391-01-5 85409-23-0
	<u>CAS No</u>	<u>State</u> Liquid	<u>Storage Container</u> Plastic Bottle or Jug			<u>Pressue</u> Ambient	<u>Waste Code</u>			
	Map: 2700 Grid: E3	<u>Type</u> Mixture	Days on Site: 365			<u>Temperature</u> Ambient				
	<b>CEMENT</b>	<b>Pounds</b>	<b>1000</b>	<b>50</b>	<b>800</b>		- Health Carcinogenicity - Health Skin Corrosion Irritation - Health Respiratory Skin Sensitization - Health Serious Eye Damage Eye Irritation - Health Specific Target Organ Toxicity	Portland cement Sand Silica sand Calcium sulfate Lithium carbonate		65997151 308075072 14808-60-7 7778189 554132
	<u>CAS No</u>	<u>State</u> Solid	<u>Storage Container</u> Bag			<u>Pressue</u> Ambient	<u>Waste Code</u>			
	Map: 2700 Grid: G3	<u>Type</u> Mixture	Days on Site: 365			<u>Temperature</u> Ambient				

## Hazardous Materials And Wastes Inventory Matrix Report

CERS Business/Org. <b>Shasta Tehama Trinity Joint Community College</b> Facility Name <b>Shasta Tehama Trinity Joint Community College</b> 11555 Old Oregon Trail, Redding 96003	Chemical Location <b>BLDG 2950, OUTSIDE</b>	CERS ID <b>10490839</b> Facility ID <b>45-000-000858</b> Status <b>Submitted on 3/4/2026 4:23 PM</b>
--	--	--

DOT Code/Fire Haz. Class	Common Name	Unit	Quantities			Annual Waste Amount	Federal Hazard Categories	Hazardous Components (For mixture only)		
			Max. Daily	Largest Cont.	Avg. Daily			Component Name	% Wt	EHS CAS No.
DOT: 2.1 - Flammable Gases	<b>PROPANE</b>	<b>Gallons</b>	<b>74</b>	<b>8</b>	<b>44</b>		- Physical	Propane	100%	74986
Flammable Gas	<u>CAS No</u> 74986 Map: 2700 Grid: E5	<u>State</u> Gas <u>Type</u> Pure	<u>Storage Container</u> Cylinder  Days on Site: 365		<u>Pressue</u> > Ambient <u>Temperature</u> Ambient	<u>Waste Code</u>	Flammable - Physical Gas Under Pressure - Health Simple Asphyxiant			
DOT: 4.1 - Flammable Solids	<b>WASTE OILY DEBRIS</b>	<b>Pounds</b>	<b>500</b>	<b>500</b>	<b>200</b>	<b>900</b>		VARIOUS LUBRICATING OILS MIXED ABSORBENTS AND DEBRIS	10% 90%	6474X-XX-X MIXTURE
	<u>CAS No</u>  Map: 2700 Grid: D2	<u>State</u> Solid <u>Type</u> Waste	<u>Storage Container</u> Steel Drum  Days on Site: 365		<u>Pressue</u> Ambient <u>Temperature</u> Ambient	<u>Waste Code</u> 223				
Combustible Liquid, Class III-B	<b>WASTE STORAGE SOLUTION WITH LAB SPECIMENS</b>	<b>Gallons</b>	<b>55</b>	<b>55</b>	<b>55</b>	<b>55</b>	- Health Carcinogenicity	PROPYLENE GLYCOL 2-PHENOXYETHANOL 2-AMINO-2-ETHYL-1,3- PROPANEDIOL		57556 122996 115708
	<u>CAS No</u>  Map: 2700 Grid: D2	<u>State</u> Liquid <u>Type</u> Waste	<u>Storage Container</u> Plastic/Non-metalic Drum  Days on Site: 365		<u>Pressue</u> Ambient <u>Temperature</u> Ambient	<u>Waste Code</u> 551	- Health Acute Toxicity - Health Skin Corrosion Irritation			
DOT: 3 - Flammable and Combustible Liquids	<b>DIESEL #2</b>	<b>Gallons</b>	<b>190</b>	<b>190</b>	<b>190</b>		- Physical Flammable			
Combustible Liquid, Class II	<u>CAS No</u> 68476-34-6 Map: 1 Grid: F3	<u>State</u> Liquid <u>Type</u> Pure	<u>Storage Container</u> Other  Days on Site: 365		<u>Pressue</u> Ambient <u>Temperature</u> Ambient	<u>Waste Code</u>	- Health Carcinogenicity - Health Acute Toxicity - Health Skin Corrosion Irritation - Health Specific Target Organ Toxicity - Health Aspiration Hazard			

## Hazardous Materials And Wastes Inventory Matrix Report

CERS Business/Org. <b>Shasta Tehama Trinity Joint Community College</b>	Chemical Location <b>BLDG 3200, OUTSIDE</b>	CERS ID <b>10490839</b>
Facility Name <b>Shasta Tehama Trinity Joint Community College</b> 11555 Old Oregon Trail, Redding 96003		Facility ID <b>45-000-000858</b>
		Status <b>Submitted on 3/4/2026 4:23 PM</b>

DOT Code/Fire Haz. Class	Common Name	Unit	Quantities			Annual Waste Amount	Federal Hazard Categories	Hazardous Components (For mixture only)		
			Max. Daily	Largest Cont.	Avg. Daily			Component Name	% Wt	EHS CAS No.
Combustible Liquid, Class III-B	<b>TRANSFORMER OIL</b>	<b>Gallons</b>	<b>354</b>	<b>194</b>	<b>354</b>		- Health	Mineral Oil	100%	8020835
	<u>CAS No</u>	<u>State</u>	<u>Storage Container</u>		<u>Pressure</u>	<u>Waste Code</u>	Aspiration Hazard			
	64742-53-6	Liquid	Other		Ambient					
	<u>Map: 1</u> <u>Grid: C4</u>	<u>Type</u>			<u>Temperature</u>					
		Mixture	Days on Site: 365		Ambient					

## Hazardous Materials And Wastes Inventory Matrix Report

CERS Business/Org. <b>Shasta Tehama Trinity Joint Community College</b>	Chemical Location <b>BLDG 3300, OUTSIDE</b>	CERS ID <b>10490839</b>
Facility Name <b>Shasta Tehama Trinity Joint Community College</b> 11555 Old Oregon Trail, Redding 96003		Facility ID <b>45-000-000858</b>
		Status <b>Submitted on 3/4/2026 4:23 PM</b>

DOT Code/Fire Haz. Class	Common Name	Unit	Quantities			Annual Waste Amount	Federal Hazard Categories	Hazardous Components (For mixture only)		
			Max. Daily	Largest Cont.	Avg. Daily			Component Name	% Wt	EHS CAS No.
DOT: 3 - Flammable and Combustible Liquids	<b>DIESEL #2</b>	<b>Gallons</b>	<b>190</b>	<b>190</b>	<b>190</b>			Diesel Fuel No. 2	100%	68476302
Combustible Liquid, Class II	CAS No <b>68476302</b> Map: 1 Grid: C4	State <b>Liquid</b> Type <b>Mixture</b>	Storage Container <b>Aboveground Tank, Other</b> Days on Site: 365	Pressue <b>Ambient</b>	Waste Code					

## Hazardous Materials And Wastes Inventory Matrix Report

CERS Business/Org. <b>Shasta Tehama Trinity Joint Community College</b> Facility Name <b>Shasta Tehama Trinity Joint Community College</b> 11555 Old Oregon Trail, Redding 96003	Chemical Location <b>BLDG 4200</b>	CERS ID <b>10490839</b> Facility ID <b>45-000-000858</b> Status <b>Submitted on 3/4/2026 4:23 PM</b>
--	---------------------------------------	--

DOT Code/Fire Haz. Class	Common Name	Unit	Quantities			Annual Waste Amount	Federal Hazard Categories	Hazardous Components (For mixture only)		
			Max. Daily	Largest Cont.	Avg. Daily			Component Name	% Wt	EHS CAS No.
DOT: 5.1 - Oxidizing Substances	<b>OXYGEN</b>	<b>Cu. Feet</b>	<b>281</b>	<b>281</b>	135		- Physical Gas Under Pressure	Oxygen, Compressed	100%	7782447
Oxidizing Gas, Gaseous	<u>CAS No</u> 7782447 Map: 4200 Grid: C9	<u>State</u> Gas <u>Type</u> Pure	<u>Storage Container</u> Cylinder		<u>Pressue</u> > Ambient <u>Temperature</u> Ambient	<u>Waste Code</u>	- Physical Oxidizer			
DOT: 2.1 - Flammable Gases	<b>PROPANE</b>	<b>Gallons</b>	<b>42</b>	<b>30</b>	20		- Physical Flammable	PROPANE	100%	74986
Flammable Gas	<u>CAS No</u> 74986 Map: 4200 Grid: C9	<u>State</u> Gas <u>Type</u> Pure	<u>Storage Container</u> Cylinder		<u>Pressue</u> > Ambient <u>Temperature</u> Ambient	<u>Waste Code</u>	- Physical Gas Under Pressure - Health Simple Asphyxiant			
	<b>CEMENT</b>	<b>Pounds</b>	<b>1000</b>	<b>50</b>	500		- Health Carcinogenicity			
	<u>CAS No</u> 65997-15-1	<u>State</u> Solid <u>Type</u> Mixture	<u>Storage Container</u> Bag		<u>Pressue</u> Ambient <u>Temperature</u> Ambient	<u>Waste Code</u>	- Health Skin Corrosion Irritation - Health Respiratory Skin Sensitization - Health Serious Eye Damage Eye Irritation - Health Specific Target Organ Toxicity			

## Hazardous Materials And Wastes Inventory Matrix Report

CERS Business/Org. <b>Shasta Tehama Trinity Joint Community College</b>	Chemical Location <b>BLDG 4200, OUTSIDE</b>	CERS ID <b>10490839</b>
Facility Name <b>Shasta Tehama Trinity Joint Community College</b> 11555 Old Oregon Trail, Redding 96003		Facility ID <b>45-000-000858</b>
		Status <b>Submitted on 3/4/2026 4:23 PM</b>

DOT Code/Fire Haz. Class	Common Name	Unit	Quantities			Annual Waste Amount	Federal Hazard Categories	Hazardous Components (For mixture only)		
			Max. Daily	Largest Cont.	Avg. Daily			Component Name	% Wt	EHS CAS No.
DOT: 3 - Flammable and Combustible Liquids Combustible Liquid, Class III-B	<b>Motor Oil/Hydraulic Oil/Gear Oil</b>  CAS No. 64742547 Map: 4200 Grid: C7	<b>Gallons</b>	<b>240</b>	<b>55</b>	130	55	- Physical Flammable	Lubricating Oil (Petroleum-Based)	100%	8020835
		<u>State</u> Liquid	<u>Storage Container</u> Steel Drum, Plastic/Non-metallic		<u>Pressue</u> Ambient	<u>Waste Code</u>				
		<u>Type</u> Mixture	<u>Drum</u> Days on Site: 365		<u>Temperature</u> Ambient					
DOT: 3 - Flammable and Combustible Liquids Combustible Liquid, Class III-B	<b>WASTE OIL</b>  CAS No. Map: 4200 Grid: C7	<b>Gallons</b>	<b>110</b>	<b>55</b>	60	55	- Physical Flammable	WASTE OIL, PETROLEUM BASED	100%	0
		<u>State</u> Liquid	<u>Storage Container</u> Steel Drum		<u>Pressue</u> Ambient	<u>Waste Code</u> 221	- Health Carcinogenicity			
		<u>Type</u> Mixture	<u>Days on Site</u> Days on Site: 365		<u>Temperature</u> Ambient		- Health Acute Toxicity - Health Reproductive Toxicity - Health Skin Corrosion Irritation - Health Respiratory Skin Sensitization - Health Serious Eye Damage Eye Irritation - Health Specific Target Organ Toxicity - Health Aspiration Hazard			

## Hazardous Materials And Wastes Inventory Matrix Report

CERS Business/Org. <b>Shasta Tehama Trinity Joint Community College</b>	Chemical Location <b>FOOTBALL BLEACHERS</b>	CERS ID <b>10490839</b>
Facility Name <b>Shasta Tehama Trinity Joint Community College</b> 11555 Old Oregon Trail, Redding 96003		Facility ID <b>45-000-000858</b>
		Status <b>Submitted on 3/4/2026 4:23 PM</b>

DOT Code/Fire Haz. Class	Common Name	Unit	Quantities			Annual Waste Amount	Federal Hazard Categories	Hazardous Components (For mixture only)		
			Max. Daily	Largest Cont.	Avg. Daily			Component Name	% Wt	EHS
Combustible Liquid, Class III-B	<b>TRANSFORMER OIL</b>	<b>Gallons</b>	<b>162</b>	<b>162</b>	<b>162</b>		- Health	Mineral Oil	100%	8020835
	<u>CAS No</u>	<u>State</u>	<u>Storage Container</u>		<u>Pressue</u>	<u>Waste Code</u>	Aspiration Hazard			
	64742-53-6	Liquid	Other		Ambient					
	<u>Map: 1</u> <u>Grid: E3</u>	<u>Type</u>			<u>Temperature</u>					
		Mixture	Days on Site: 365		Ambient					

## Hazardous Materials And Wastes Inventory Matrix Report

CERS Business/Org. <b>Shasta Tehama Trinity Joint Community College</b>	Chemical Location <b>SOLAR FIELD</b>	CERS ID <b>10490839</b>
Facility Name <b>Shasta Tehama Trinity Joint Community College</b> 11555 Old Oregon Trail, Redding 96003		Facility ID <b>45-000-000858</b>
		Status <b>Submitted on 3/4/2026 4:23 PM</b>

DOT Code/Fire Haz. Class	Common Name	Unit	Quantities			Annual Waste Amount	Federal Hazard Categories	Hazardous Components (For mixture only)		
			Max. Daily	Largest Cont.	Avg. Daily			Component Name	% Wt	EHS CAS No.
Combustible Liquid, Class III-B	<b>TRANSFORMER OIL</b>	<b>Gallons</b>	<b>300</b>	<b>300</b>	<b>300</b>		- Health	Mineral Oil	100%	8020835
	<u>CAS No</u>	<u>State</u>	<u>Storage Container</u>		<u>Pressure</u>	<u>Waste Code</u>	Aspiration Hazard			
	64742-53-6	Liquid	Other		Ambient					
	Map: 1 Grid: D1	<u>Type</u>			<u>Temperature</u>					
		Mixture	Days on Site: 365		Ambient					



**Site Plan**

**Site Plan**

Emergency Coord: Joe Trompczynski  
 Alternative E.C.: Andy Brown  
 911 in case of emergency

530.949.8279  
 530.410.1968  
 SC\_HMBP\_SitePlan\_190606.ai  
 ©Shasta College HMCO; G.W.



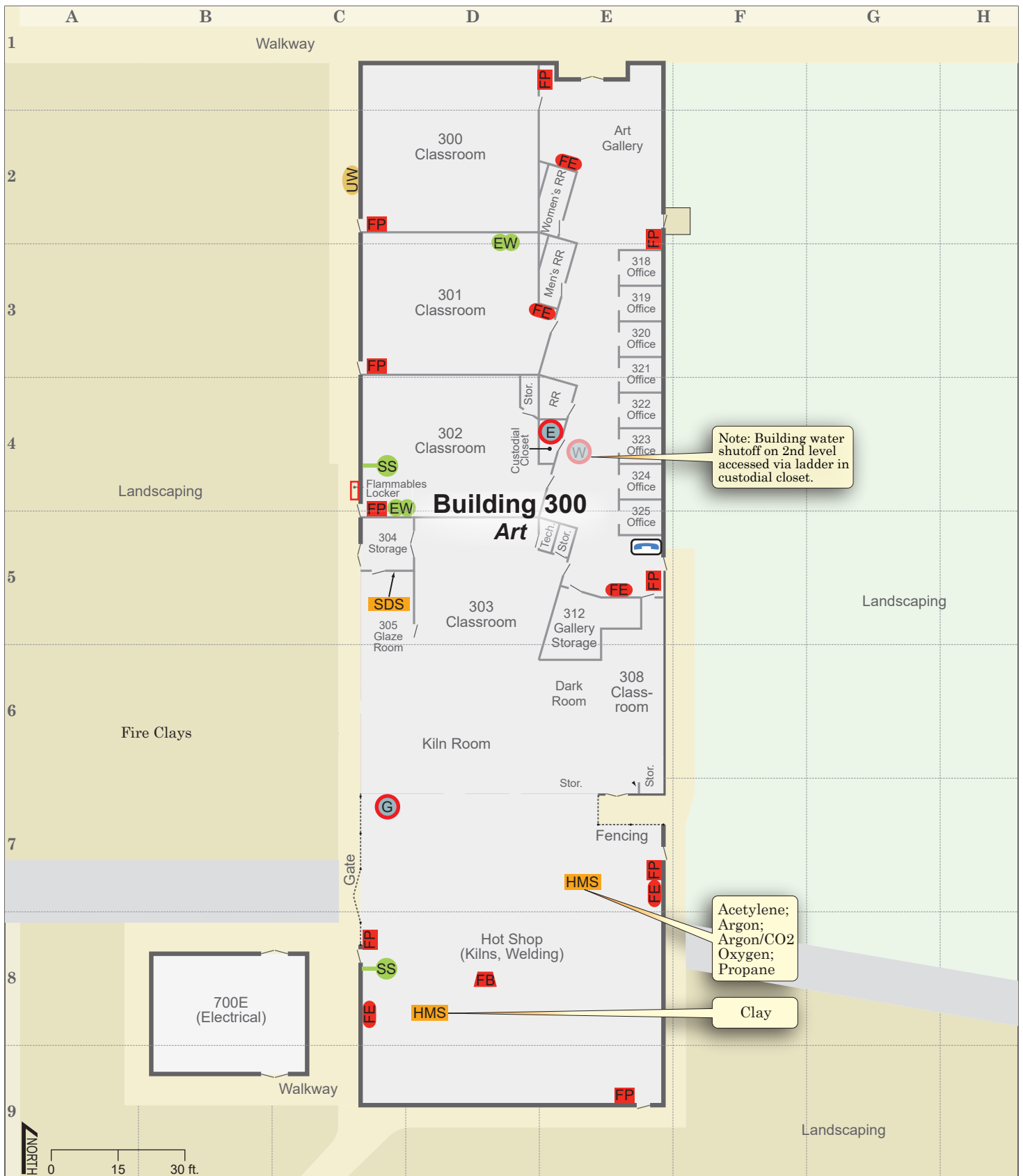

**Legend**

- |  |                               |                                   |                         |
|--|-------------------------------|-----------------------------------|-------------------------|
| <b>SDS</b> Safety Data Sheets          | <b>FP</b> Fire Alarm Pull-Box | <b>E</b> Bldg. Electrical Shutoff | <b>☎</b> Security Phone |
| <b>HMS</b> Hazardous Materials Storage | <b>UW</b> Universal Waste     | <b>G</b> Bldg. Gas Shutoff        |                         |
| <b>FE</b> Fire Extinguisher            | <b>EW</b> Eye Wash            | <b>W</b> Bldg. Water Shutoff      |                         |
| <b>FB</b> Fire Blanket                 | <b>SS</b> Safety Shower       |                                   |                         |

**Map 300**

**Building 300 - Art**

Emergency Coord: Joe Trompczynski 530.949.8279  
 Alternative E.C.: **Andy Brown** 530.410.1968  
**911 in case of emergency**  
HMBP\_Bldg0300A\_190606.ai  
 ©Shasta College HMCP; G.W.

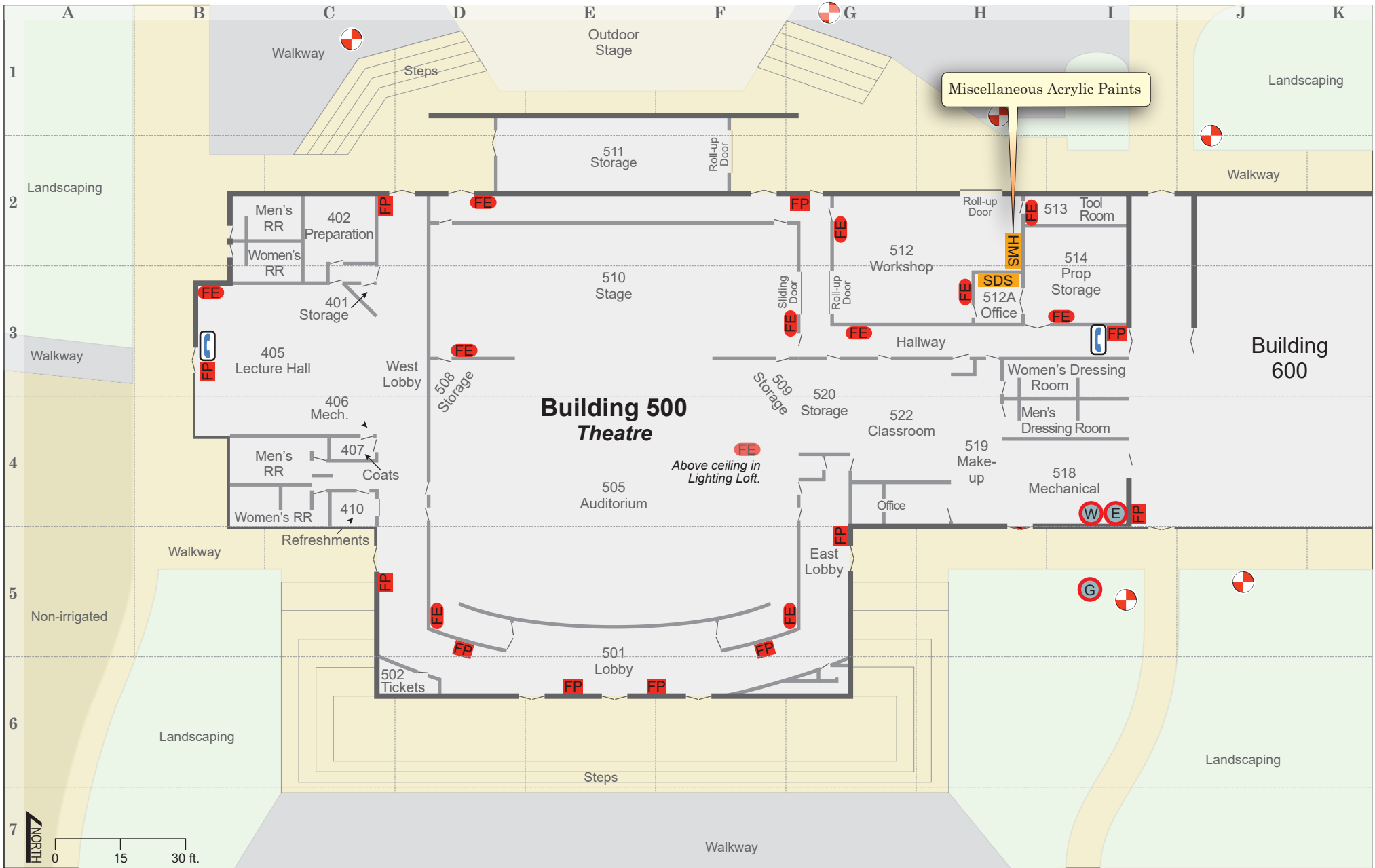

**Legend**

- Safety DataSheets
- Fire Extinguisher
- Bldg. Electrical Shutoff
- Water Shutoff
- Hazardous Materials Storage
- Fire Alarm Pull-Box
- Gas Shutoff
- Security Phone
- Storm Drain

**Map 500**

**Building 500 - Theatre**

Emergency Coord.: Joe Trompczynski  
 Alternative EC: Andy Brown  
 Contact 911 in case of emergency  
 530.949.8279  
 530.410.1968  
HMBP\_Bldg0500\_190622.ai  
 ©Shasta College HMCP: G.W.

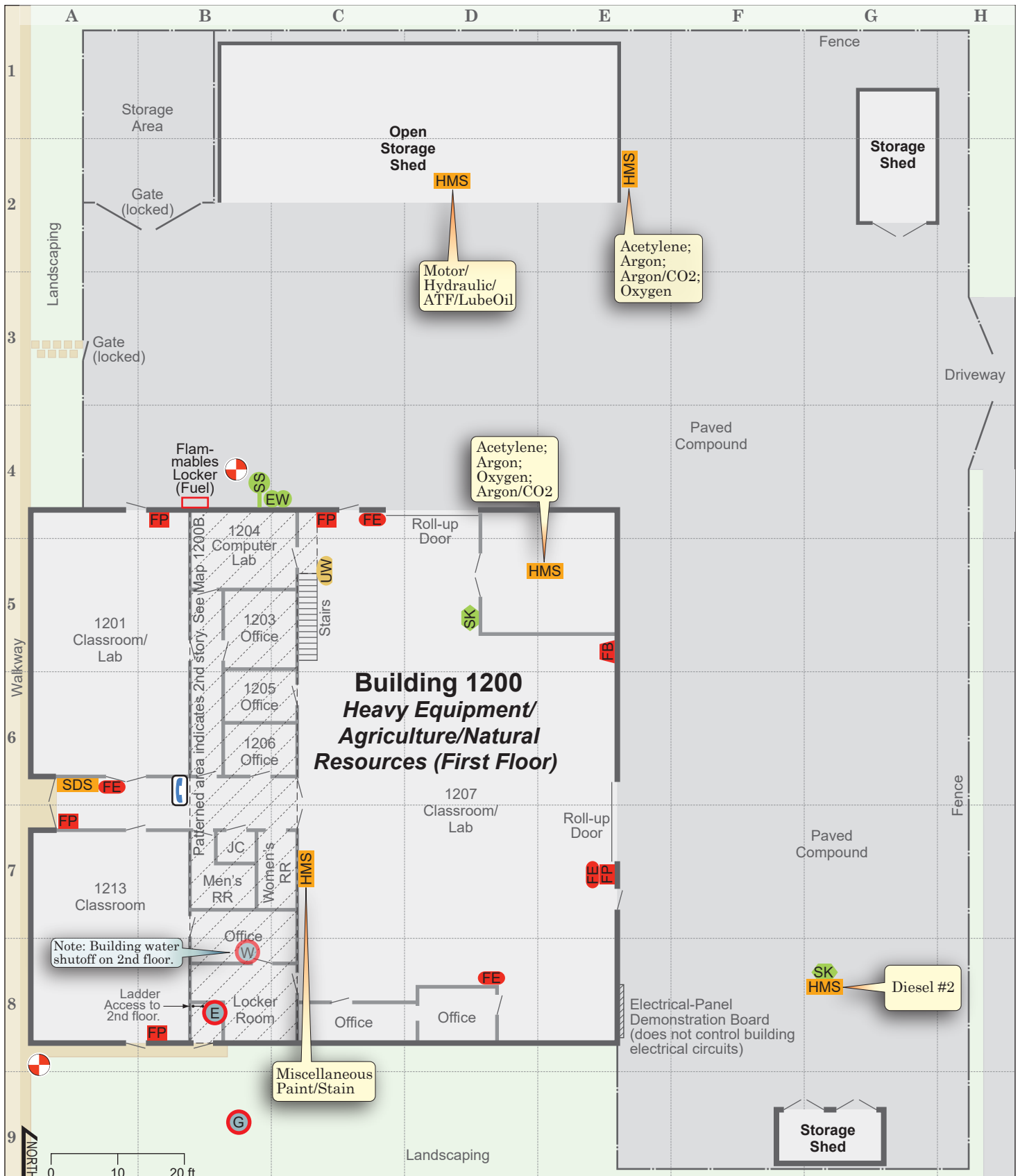

**Legend**

- |                             |                     |                          |                 |
|-----------------------------|---------------------|--------------------------|-----------------|
| Safety Data Sheets          | Fire Alarm Pull-Box | Bldg. Electrical Shutoff | Security Phone  |
| Hazardous Materials Storage | Eye Wash            | Bldg. Gas Shutoff        | Universal Waste |
| Fire Extinguisher           | Safety Shower       | Bldg. Water Shutoff      | Storm Drain     |
| Fire Blanket                | Spill Kit           |                          |                 |

**Map 1200**

**Building 1200 - Heavy Equipment/  
Agriculture/Natural Resources**

Emergency Coord: Joe Trompczynski 530.949.8279  
 Alternative E.C.: **Andy Brown** 530.410.1968  
**911 in case of emergency**

HMBP: Bldg1200A\_190606.ai  
 ©Shasta College HMCP, G.W.

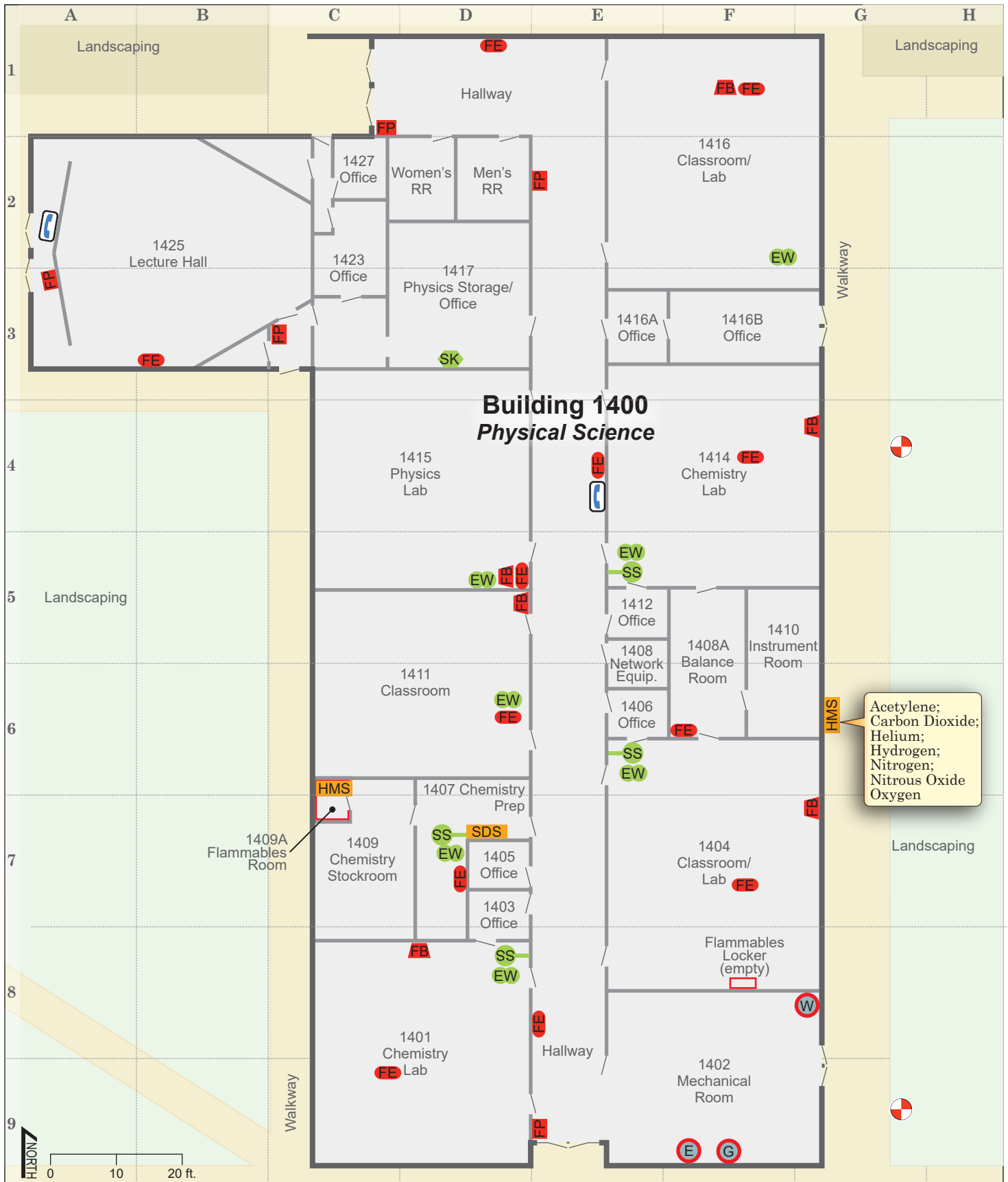

Acetylene;  
Carbon Dioxide;  
Helium;  
Hydrogen;  
Nitrogen;  
Nitrous Oxide  
Oxygen

**Legend**

- |                             |                     |                          |                |
|-----------------------------|---------------------|--------------------------|----------------|
| SDS Safety Data Sheets      | Fire Alarm Pull-Box | Bldg. Electrical Shutoff | Security Phone |
| Hazardous Materials Storage | Eye Wash            | Bldg. Gas Shutoff        | Storm Drain    |
| Fire Extinguisher           | Safety Shower       | Bldg. Water Shutoff      |                |
| Fire Blanket                | Spill Kit           |                          |                |

**Map 1400**

**Building 1400 - Physical Science**

Emergency Coord: Joe Trompczynski 530.949.8279  
 Alternative E.C.: **Andy Brown** 530.410.1968  
 911 in case of emergency

HMBP\_Bldg1400A\_190606.ai  
 ©Shasta College HMCP, G.W.



**Building 1600**  
*Life Science*

Waste Storage Solution with Lab Specimens

**Legend**

- |                             |                     |                          |                |
|-----------------------------|---------------------|--------------------------|----------------|
| SDS Safety Data Sheets      | Fire Alarm Pull-Box | Bldg. Electrical Shutoff | Security Phone |
| HWS Hazardous Waste Storage | Eye Wash            | Bldg. Gas Shutoff        | Storm Drain    |
| Fire Extinguisher           | Safety Shower       | Bldg. Water Shutoff      |                |
| Fire Blanket                | Spill Kit           |                          |                |

**Map 1600A**

**Building 1600 - Life Science**

Emergency Coord: Joe Trompczynski 530.949.8279  
 Alternative E.C.: **Andy Brown** 530.410.1968  
**911 in case of emergency**  
HMBP\_Bldg1600A\_190606ai  
 ©Shasta College HMCP; G.W.



**Legend**

- SDS Safety Data Sheets
- HMS Hazardous Materials Storage
- FE Fire Extinguisher
- FP Fire Alarm Pull-Box
- EW Eye Wash
- SS Safety Shower
- SK Spill Kit
- E Bldg. Electrical Shutoff
- G Bldg. Gas Shutoff
- W Bldg. Water Shutoff

**Map 1800**

**Building 1800 - Physical Education**

Emergency Coord: Joe Trompczynski 530.949.8279  
 Alternative E.C.: Andy Brown 530.410.1968  
**911 in case of emergency**

HMBP\_Bldg1800A\_190606.ai  
 ©Shasta College HMCPC, G.W.

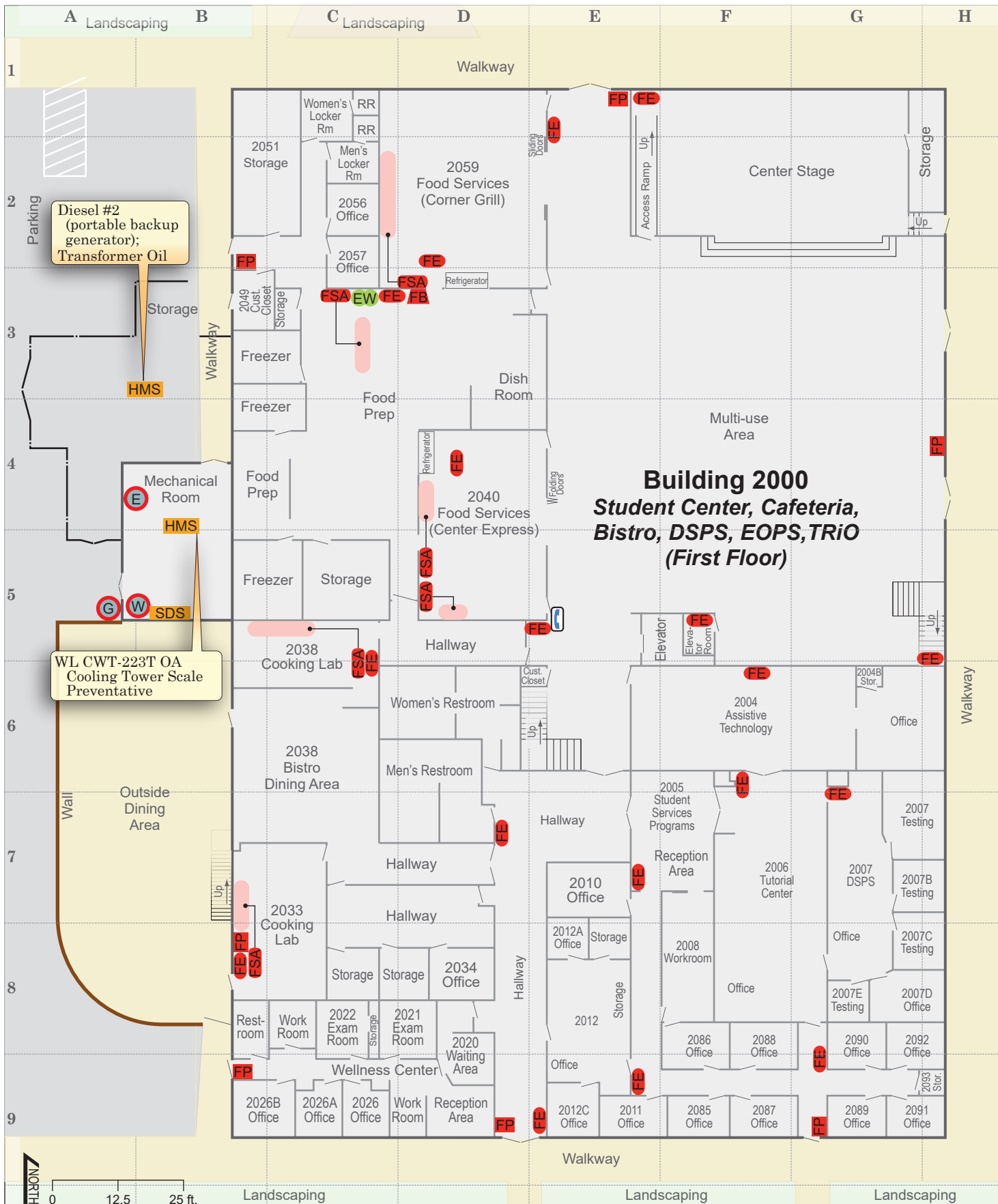

**Building 2000**  
**Student Center, Cafeteria,**  
**Bistro, DSPS, EOPS, TRiO**  
**(First Floor)**

WL CWT-223T OA  
 Cooling Tower Scale  
 Preventative

Diesel #2  
 (portable backup  
 generator);  
 Transformer Oil

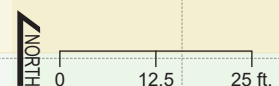

- Legend**
- SDS** Safety Data Sheets
  - FE** Fire Extinguisher
  - EW** Eye Wash
  - G** Bldg. Gas Shutoff
  - HMS** Hazardous Materials Storage
  - FP** Fire Alarm Pull-Box
  - SP** Security Phone
  - W** Bldg. Water Shutoff
  - FSA** Fire Extinguisher System Activator
  - SA** Suppression Area
  - FB** Fire Blanket
  - E** Bldg. Electrical Shutoff

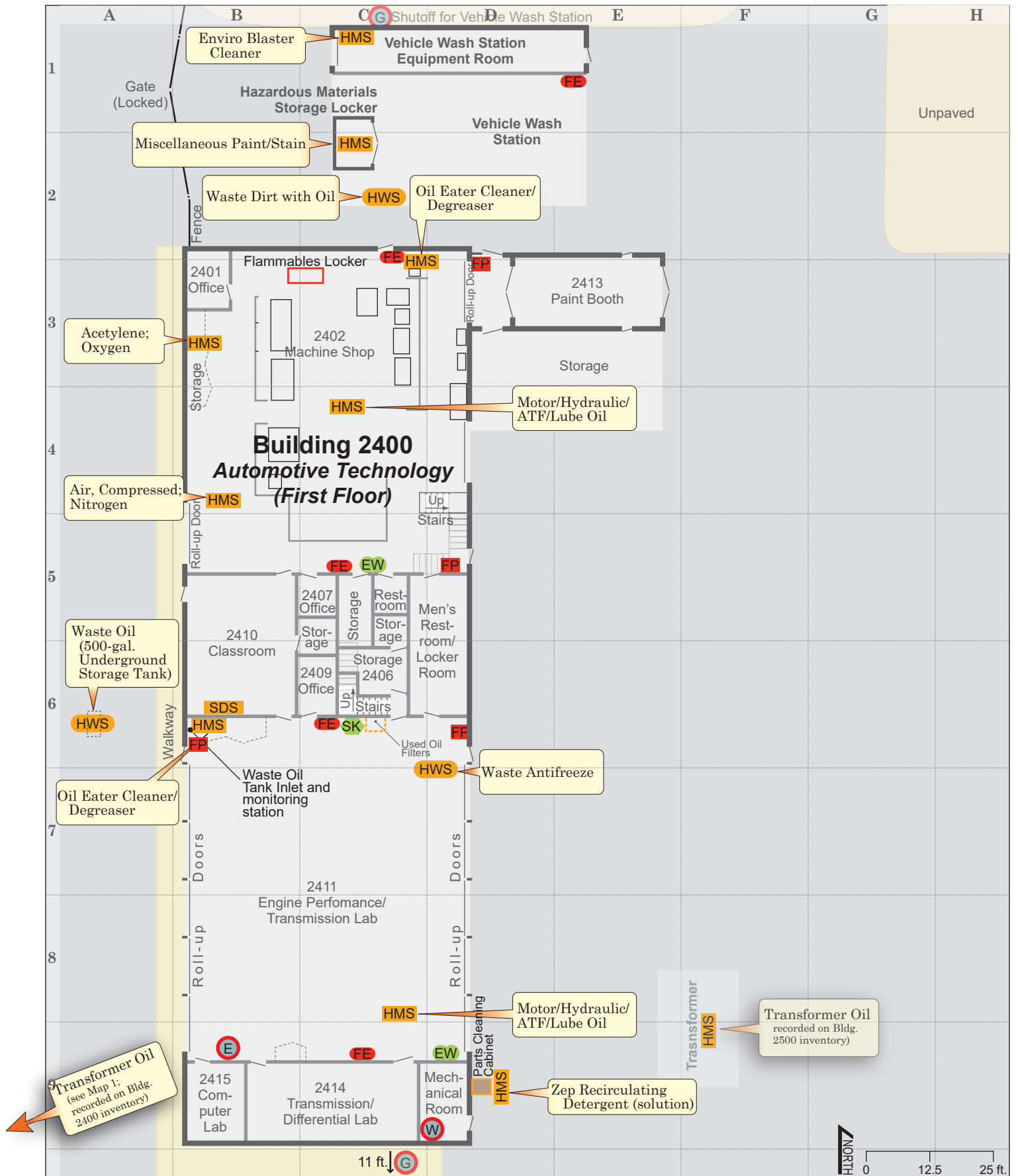

**Legend**

- |                             |                     |           |                          |
|-----------------------------|---------------------|-----------|--------------------------|
| Safety Data Sheets          | Fire Extinguisher   | Eye Wash  | Bldg. Gas Shutoff        |
| Hazardous Materials Storage | Fire Alarm Pull-Box | Spill Kit | Bldg. Water Shutoff      |
| Hazardous Waste Storage     |                     |           | Bldg. Electrical Shutoff |

**Map 2400**

**Building 2400 - Automotive Technology**

Emergency Coord: Joe Trompczynski 530.949.8279  
 Alternative E.C.: Andy Brown 530.410.1968  
**911 in case of emergency**  
HMBP\_Bldg2400A\_200221.ai ©Shasta College HMCP; G.W.

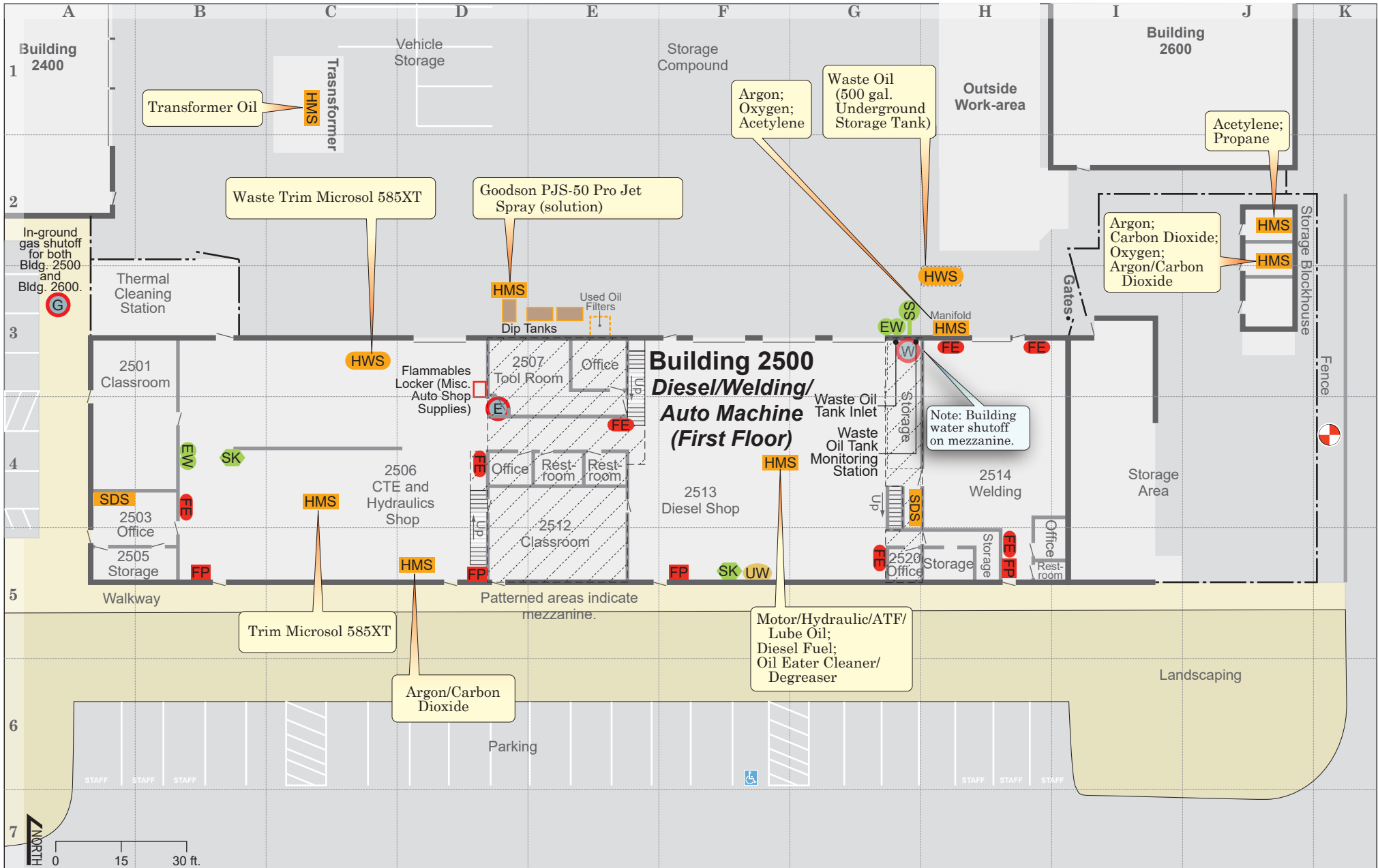

Legend					
SDS	Safety Data Sheets Station	HWS	Hazardous Waste Storage	EW	Eye Wash
HMS	Hazardous Materials Storage	FE	Fire Extinguisher	SS	Safety Shower
		FP	Fire Alarm Pull-Box	SK	Spill Kit
				UW	Universal Waste
				W	Water Shutoff
				E	Bldg. Electrical Shutoff
				SD	Storm Drain
				G	Gas Shutoff

**Map 2500**

**Building 2500 - Diesel/Welding/Auto Machine**

Emergency Coord: Joe Trompczynski 530.949.8279  
 Alternative E.C.: Andy Brown 530.410.1968  
 911 in case of emergency

HMBP\_Bldg2500A\_190606.ai  
 ©Shasta College HMCP; G.W.



**Legend**

- |                                 |                             |                |                          |
|---------------------------------|-----------------------------|----------------|--------------------------|
| SDS Safety Data Sheets          | Fire Extinguisher           | Security Phone | Bldg. Electrical Shutoff |
| HMS Hazardous Materials Storage | Fire Extinguisher and Water | Storm Drain    | Bldg. Gas Shutoff        |
| Fire Blanket                    | Eye Wash                    |                | Bldg. Water Shutoff      |
|                                 | Safety Shower               |                |                          |

**Map 2600**

**Building 2600 - Welding**

Emergency Coord: Joe Trompczynski 530.949.8279  
 Alternative E.C.: **Andy Brown** 530.410.1968  
**911 in case of emergency**  
HMBP\_Bldg2600A\_190606.ai  
 ©Shasta College HMCP; G.W.

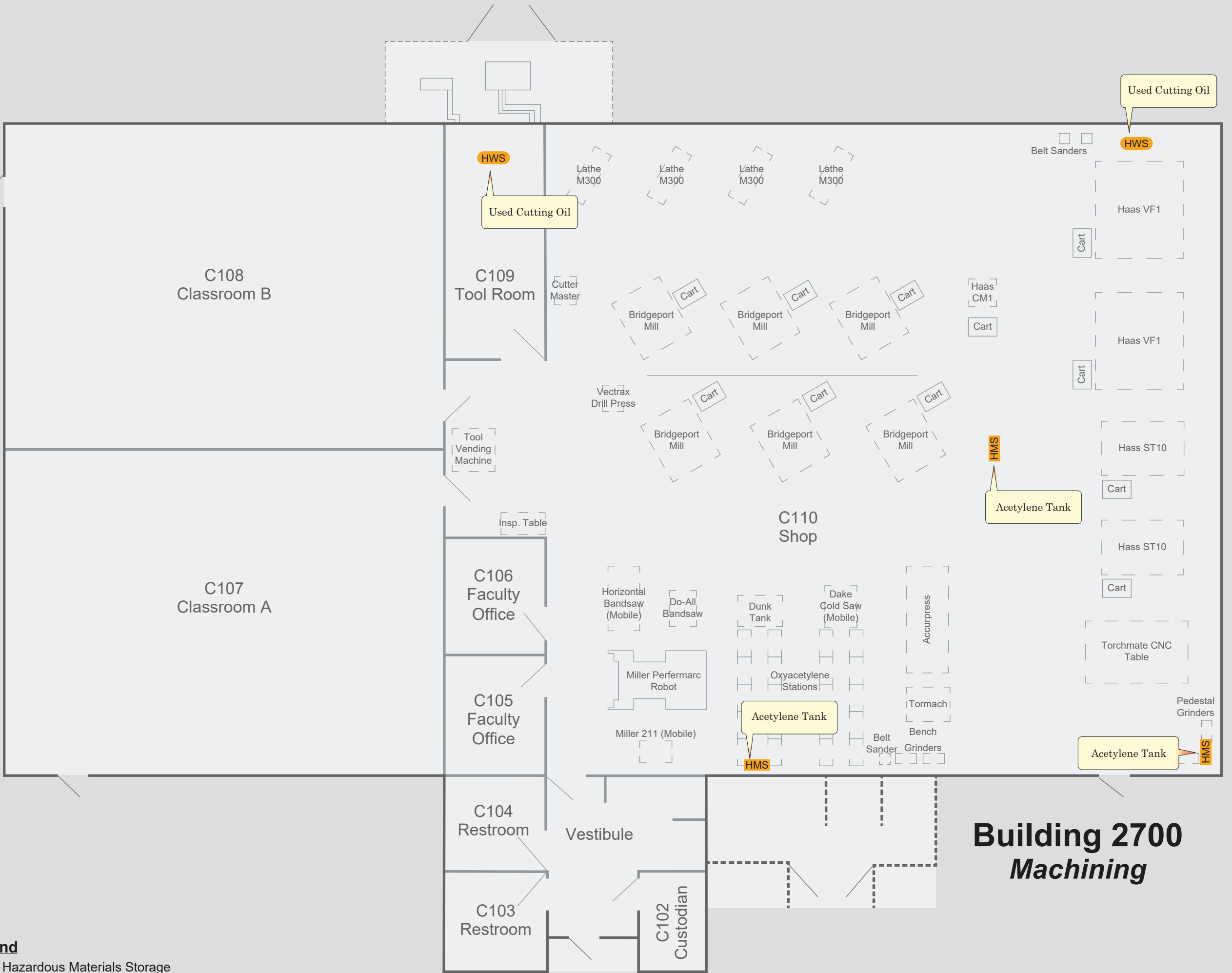

**Legend**  
**HMS** Hazardous Materials Storage  
**HWS** Hazardous Waste Storage

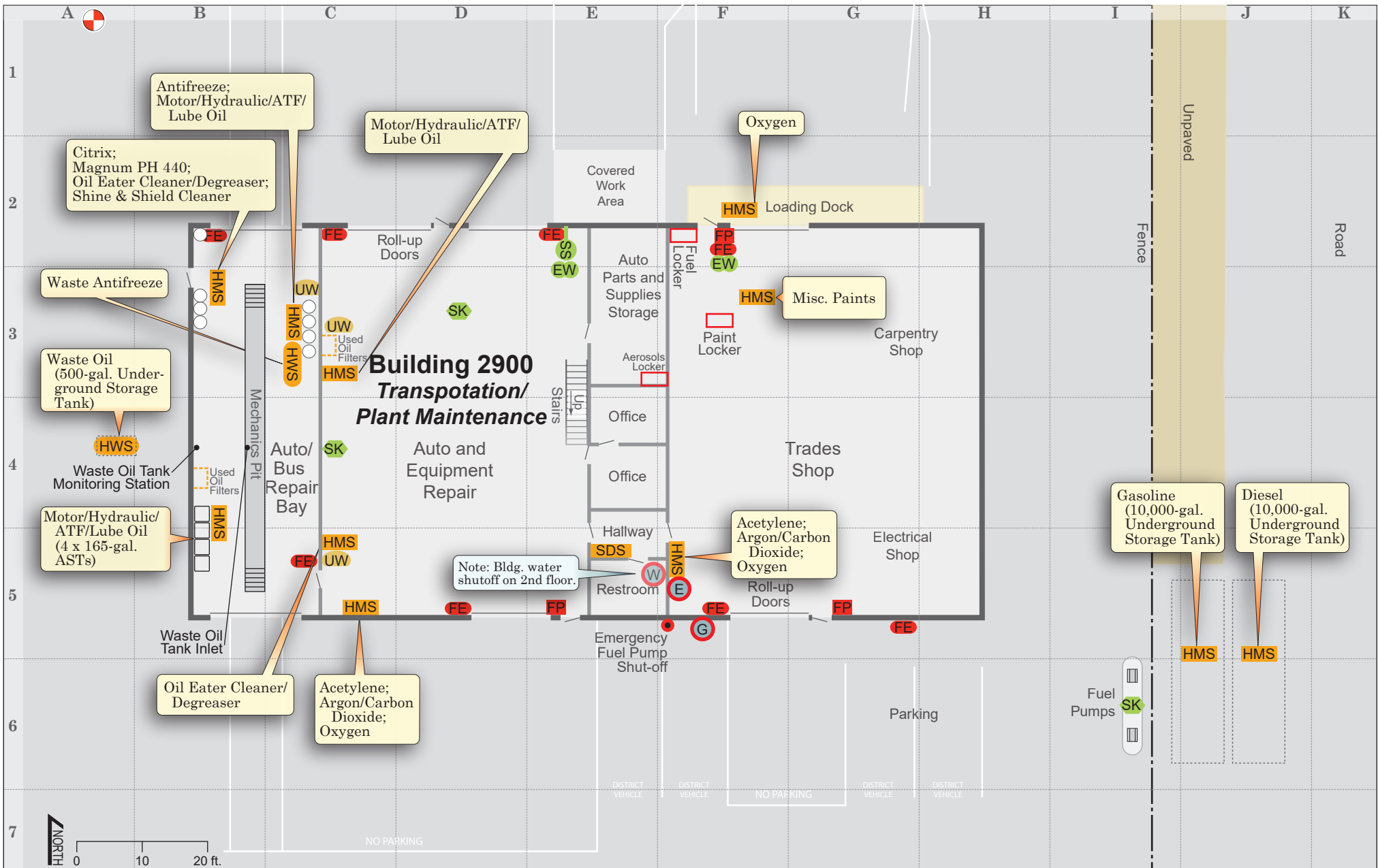

<b>Legend</b>	<b>HWS</b> Hazardous Waste Storage	<b>SS</b> Safety Shower	<b>●</b> Emergency Fuel-Pump Shut-off	<b>E</b> Bldg. Electrical Shutoff
<b>SDS</b> Safety Data Sheets	<b>FE</b> Fire Extinguisher	<b>EW</b> Eye Wash	<b>UW</b> Universal Waste Receptical	<b>G</b> Bldg. Gas Shutoff
<b>HMS</b> Hazardous Materials Storage	<b>FP</b> Fire Alarm Pull-Box	<b>SK</b> Spill Kit	<b>⊗</b> Storm Drain	<b>W</b> Bldg. Water Shutoff

**Map 2900**

**Building 2900 - Transportation/Plant Maintenance**

Emergency Coord: Joe Trompczynski 530.949.8279  
 Alternative E.C.: Andy Brown 530.410.1968  
**911 in case of emergency**

HMBP\_Bldg2900A\_190606.ai  
 ©Shasta College HMCP: G.W.



**Legend**

- |                             |                         |                            |                          |
|-----------------------------|-------------------------|----------------------------|--------------------------|
| SDS Safety Data Sheets      | Hazardous Waste Storage | Universal Waste Receptical | Bldg. Electrical Shutoff |
| Hazardous Materials Storage | Fire Extinguisher       | Storm Drain                | Bldg. Gas Shutoff        |
|                             | Fire Alarm Pull-Box     |                            | Bldg. Water Shutoff      |

**Map 2950**

**Building 2950 - Physical Plant Division/Warehouse/Receiving**

Emergency Coord: Joe Trompczynski 530.949.8279  
 Alternative E.C.: Andy Brown 530.410.1968  
 911 in case of emergency

HMBP\_Bldg2700A\_190605.ai  
 ©Shasta College HMCP; G.W.

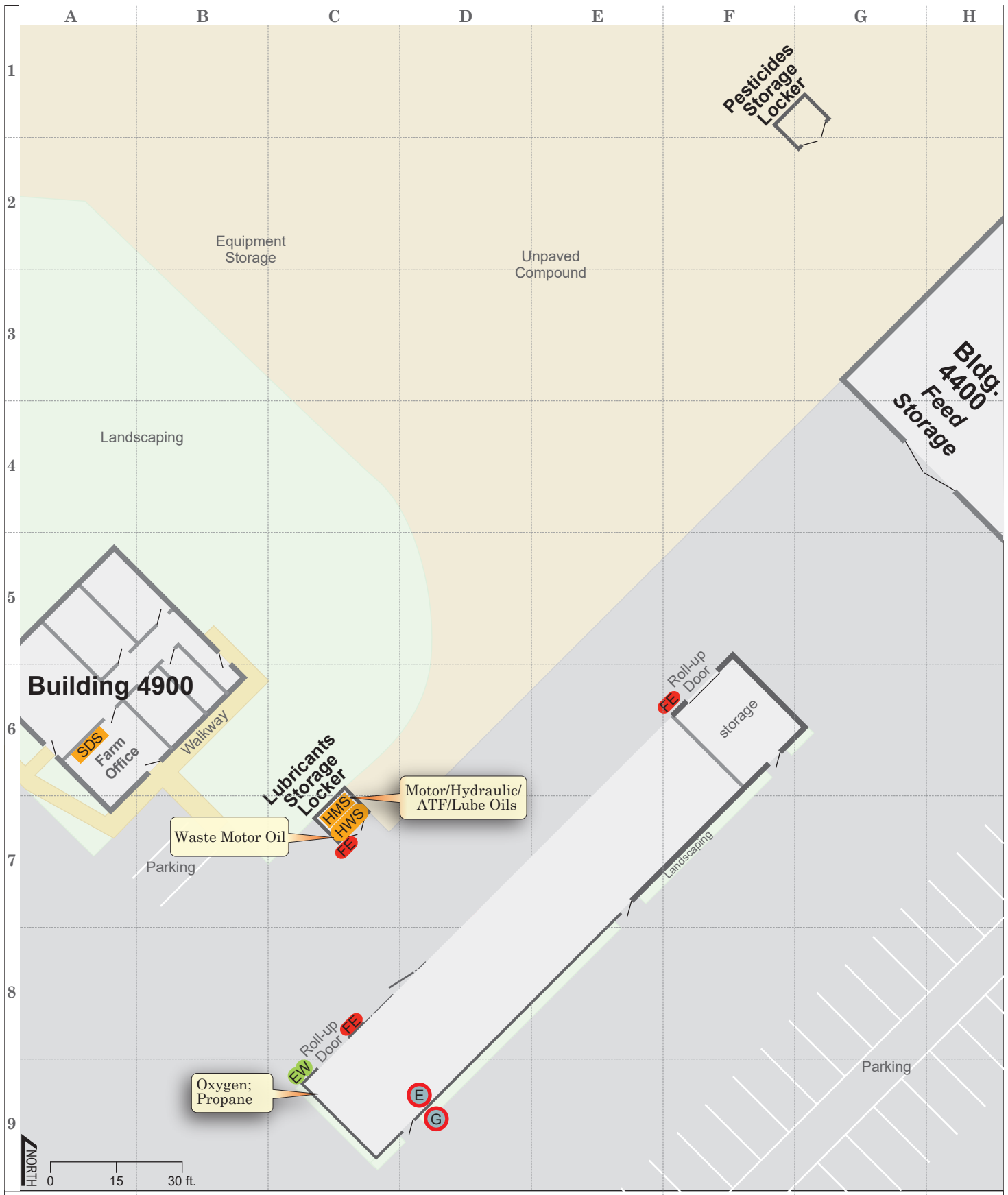

**Legend**

- |                             |                     |                      |
|-----------------------------|---------------------|----------------------|
| Safety Data Sheets          | Spill Kit           | Bldg. Elect. Shutoff |
| Hazardous Materials Storage | Fire Extinguisher   | Bldg. Gas Shutoff    |
| Eye Wash                    | Fire Alarm Pull-Box |                      |

**Map 4200**

**Building 4200 - Equipment Storage**

Emergency Coord: Joe Trompczynsk 530.949.8279  
 Alternative E.C.: **Andy Brown** 530.410.1968  
**911 in case of emergency**

HMBP\_Bldg4200A\_190305.ai  
 ©Shasta College HMCP; G.W.

**CALIFORNIA ENVIRONMENTAL REPORTING SYSTEM (CERS)**  
**CONSOLIDATED EMERGENCY RESPONSE / CONTINGENCY PLAN**

*Prior to completing this Plan, please refer to the INSTRUCTIONS FOR COMPLETING A CONSOLIDATED CONTINGENCY PLAN*

**A. FACILITY IDENTIFICATION AND OPERATIONS OVERVIEW**

FACILITY ID #	1. CERS ID	A1. DATE OF PLAN PREPARATION/REVISION	A2.
BUSINESS NAME (Same as Facility Name or DBA - Doing Business As)			3.
BUSINESS SITE ADDRESS			103.
BUSINESS SITE CITY	104.	CA	ZIP CODE 105.
TYPE OF BUSINESS (e.g., Painting Contractor)	A3.	INCIDENTAL OPERATIONS (e.g., Fleet Maintenance)	A4.
THIS PLAN COVERS CHEMICAL SPILLS, FIRES, AND EARTHQUAKES INVOLVING: (Check all that apply)			A5.
<input checked="" type="checkbox"/> 1. HAZARDOUS MATERIALS; <input type="checkbox"/> 2. HAZARDOUS WASTES			

**B. INTERNAL RESPONSE**

INTERNAL FACILITY EMERGENCY RESPONSE WILL OCCUR VIA: (Check all that apply)	B1.
<input type="checkbox"/> 1. CALLING PUBLIC EMERGENCY RESPONDERS (i.e., 9-1-1) <input type="checkbox"/> 2. CALLING HAZARDOUS WASTE CONTRACTOR <input type="checkbox"/> 3. ACTIVATING IN-HOUSE EMERGENCY RESPONSE TEAM	

**C. EMERGENCY COMMUNICATIONS, PHONE NUMBERS AND NOTIFICATIONS**

Whenever there is an imminent or actual emergency situation such as an explosion, fire, or release, the Emergency Coordinator (or his/her designee when the Emergency Coordinator is on call) shall:

1. Activate internal facility alarms or communications systems, where applicable, to notify all facility personnel.
2. Notify appropriate local authorities (i.e., call 9-1-1).
3. Notify the California Emergency Management Agency at (800) 852-7550.

Before facility operations are resumed in areas of the facility affected by the incident, the emergency coordinator shall notify the California Department of Toxic Substances Control (DTSC), the local Unified Program Agency (UPA), and the local fire department's hazardous materials program that the facility is in compliance with requirements to:

1. Provide for proper storage and disposal of recovered waste, contaminated soil or surface water, or any other material that results from an explosion, fire, or release at the facility; and
2. Ensure that no material that is incompatible with the released material is transferred, stored, or disposed of in areas of the facility affected by the incident until cleanup procedures are completed.

INTERNAL FACILITY EMERGENCY COMMUNICATIONS OR ALARM NOTIFICATION WILL OCCUR VIA: (Check all that apply)	C1.
<input type="checkbox"/> 1. VERBAL WARNINGS; <input type="checkbox"/> 2. PUBLIC ADDRESS OR INTERCOM SYSTEM; <input type="checkbox"/> 3. TELEPHONE; <input type="checkbox"/> 4. PAGERS; <input type="checkbox"/> 5. ALARM SYSTEM; <input type="checkbox"/> 6. PORTABLE RADIO	
NOTIFICATIONS TO NEIGHBORING FACILITIES THAT MAY BE AFFECTED BY AN OFF-SITE RELEASE WILL OCCUR BY: (Check all that apply)	C2.
<input type="checkbox"/> 1. VERBAL WARNINGS; <input type="checkbox"/> 2. PUBLIC ADDRESS OR INTERCOM SYSTEM; <input type="checkbox"/> 3. TELEPHONE; <input type="checkbox"/> 4. PAGERS; <input type="checkbox"/> 5. ALARM SYSTEM; <input type="checkbox"/> 6. PORTABLE RADIO	
EMERGENCY RESPONSE PHONE NUMBERS:	
AMBULANCE, FIRE, POLICE AND CHP .....	9-1-1
CALIFORNIA EMERGENCY MANAGEMENT AGENCY (CAL/EMA) .....	(800) 852-7550
NATIONAL RESPONSE CENTER (NRC) .....	(800) 424-8802
POISON CONTROL CENTER .....	(800) 222-1222
LOCAL UNIFIED PROGRAM AGENCY (UPA/CUPA) .....	C3.
OTHER (Specify):	C4. C5.
NEAREST MEDICAL FACILITY / HOSPITAL NAME:	C6. C7.
AGENCY NOTIFICATION PHONE NUMBERS:	
CALIFORNIA DEPT. OF TOXIC SUBSTANCES CONTROL (DTSC) ....	(916) 255-3545
REGIONAL WATER QUALITY CONTROL BOARD .....	C8.
U.S. ENVIRONMENTAL PROTECTION AGENCY (US EPA) .....	(800) 300-2193
CALIFORNIA DEPT OF FISH AND GAME (DFG) .....	(916) 358-2900
U.S. COAST GUARD .....	(202) 267-2180
CAL/OSHA .....	(916) 263-2800
STATE FIRE MARSHAL .....	(916) 445-8200
OTHER (Specify):	C9. C10.
OTHER (Specify):	C11. C12.

**D. EMERGENCY CONTAINMENT AND CLEANUP PROCEDURES**

SPILL PREVENTION, CONTAINMENT, AND CLEANUP PROCEDURES: (Check all boxes that apply to indicate your procedures for containing spills, releases, fires or explosions; and, preventing and mitigating associated harm to persons, property, and the environment.)

- 1. MONITOR FOR LEAKS, RUPTURES, PRESSURE BUILD-UP, ETC.;
- 2. PROVIDE STRUCTURAL PHYSICAL BARRIERS (e.g., Portable spill containment walls);
- 3. PROVIDE ABSORBENT PHYSICAL BARRIERS (e.g., Pads, pigs, pillows);
- 4. COVER OR BLOCK FLOOR AND/ OR STORM DRAINS;
- 5. BUILT-IN BERM IN WORK / STORAGE AREA;
- 6. AUTOMATIC FIRE SUPPRESSION SYSTEM;
- 7. ELIMINATE SOURCES OF IGNITION FOR FLAMMABLE HAZARDS (e.g. Flammable liquids, Propane);
- 8. STOP PROCESSES AND/OR OPERATIONS;
- 9. AUTOMATIC / ELECTRONIC EQUIPMENT SHUT-OFF SYSTEM;
- 10. SHUT-OFF WATER, GAS, ELECTRICAL UTILITIES AS APPROPRIATE;
- 11. CALL 9-1-1 FOR PUBLIC EMERGENCY RESPONDER ASSISTANCE / MEDICAL AID;
- 12. NOTIFY AND EVACUATE PERSONS IN ALL THREATENED AREAS;
- 13. ACCOUNT FOR EVACUATED PERSONS IMMEDIATELY AFTER EVACUATION CALL;
- 14. PROVIDE PROTECTIVE EQUIPMENT FOR ON-SITE RESPONSE TEAM;
- 15. REMOVE OR ISOLATE CONTAINERS / AREA AS APPROPRIATE;
- 16. HIRE LICENSED HAZARDOUS WASTE CONTRACTOR;
- 17. USE ABSORBENT MATERIAL FOR SPILLS WITH SUBSEQUENT PROPER LABELING, STORAGE, AND HAZARDOUS WASTE DISPOSAL AS APPROPRIATE;
- 18. SUCTION USING SHOP VACUUM WITH SUBSEQUENT PROPER LABELING, STORAGE, AND HAZARDOUS WASTE DISPOSAL AS APPROPRIATE;
- 19. WASH / DECONTAMINATE EQUIPMENT W/ CONTAINMENT and DISPOSAL OF EFFLUENT / RINSATE AS HAZARDOUS WASTE;
- 20. PROVIDE SAFE TEMPORARY STORAGE OF EMERGENCY-GENERATED WASTES;
- 21. OTHER (Specify):

D1.

D2.

**E. FACILITY EVACUATION**

THE FOLLOWING ALARM SIGNAL(S) WILL BE USED TO BEGIN EVACUATION OF THE FACILITY (CHECK ALL THAT APPLY):

E1.

- 1. BELLS;
- 2. HORNS/SIRENS;
- 3. VERBAL (I.E., SHOUTING);
- 4. OTHER (Specify):

E2.

THE FOLLOWING LOCATION(S) IS/ARE EVACUEE EMERGENCY ASSEMBLY AREA(S) (i.e., Front parking lot, specific street corner, etc.)

E3.

Note: The Emergency Coordinator must account for all on site employees and/or site visitors after evacuation.

EVACUATION ROUTE MAP(S) POSTED AS REQUIRED

E4.

Note: The map(s) must show primary and alternate evacuation routes, emergency exits, and primary and alternate staging areas, and must be prominently posted throughout the facility in locations where it will be visible to employees and visitors.

**F. ARRANGEMENTS FOR EMERGENCY SERVICES**

**Explanation of Requirement:** Advance arrangements with local fire and police departments, hospitals, and/or emergency services contractors should be made as appropriate for your facility. You may determine that such arrangements are not necessary.

ADVANCE ARRANGEMENTS FOR LOCAL EMERGENCY SERVICES (Check one of the following)

F1.

- 1. HAVE BEEN DETERMINED NOT NECESSARY; *or*
- 2. THE FOLLOWING ARRANGEMENTS HAVE BEEN MADE (Specify):

F2.

**G. EMERGENCY EQUIPMENT**

Check all boxes that apply to list emergency response equipment available at the facility and identify the location(s) where the equipment is kept and the equipment's capability, if applicable. [e.g.,  CHEMICAL PROTECTIVE GLOVES | Spill response kit | One time use, Oil & solvent resistant only.]

TYPE	EQUIPMENT AVAILABLE <sup>G1.</sup>	LOCATION	CAPABILITY (If applicable) <sup>G3.</sup>
<b>Safety and First Aid</b>	1. <input type="checkbox"/> CHEMICAL PROTECTIVE SUITS, APRONS, OR VESTS	G2.	G3.
	2. <input type="checkbox"/> CHEMICAL PROTECTIVE GLOVES	G4.	G5.
	3. <input type="checkbox"/> CHEMICAL PROTECTIVE BOOTS	G6.	G7.
	4. <input type="checkbox"/> SAFETY GLASSES / GOGGLES / SHIELDS	G8.	G9.
	5. <input type="checkbox"/> HARD HATS	G10.	G11.
	6. <input type="checkbox"/> CARTRIDGE RESPIRATORS	G12.	G13.
	7. <input type="checkbox"/> SELF-CONTAINED BREATHING APPARATUS (SCBA)	G14.	G15.
	8. <input type="checkbox"/> FIRST AID KITS / STATIONS	G16.	G17.
	9. <input type="checkbox"/> PLUMBED EYEWASH FOUNTAIN / SHOWER	G18.	G19.
	10. <input type="checkbox"/> PORTABLE EYEWASH KITS	G20.	G21.
	11. <input type="checkbox"/> OTHER	G22.	G23.
	12. <input type="checkbox"/> OTHER	G24.	G25.
<b>Fire Fighting</b>	13. <input type="checkbox"/> PORTABLE FIRE EXTINGUISHERS	G26.	G27.
	14. <input type="checkbox"/> FIXED FIRE SYSTEMS / SPRINKLERS / FIRE HOSES	G28.	G29.
	15. <input type="checkbox"/> FIRE ALARM BOXES OR STATIONS	G30.	G31.
	16. <input type="checkbox"/> OTHER	G32.	G33.
<b>Spill Control and Clean-Up</b>	17. <input type="checkbox"/> ALL-IN-ONE SPILL KIT	G34.	G35.
	18. <input type="checkbox"/> ABSORBENT MATERIAL	G36.	G37.
	19. <input type="checkbox"/> CONTAINER FOR USED ABSORBENT	G38.	G39.
	20. <input type="checkbox"/> BERMING / DIKING EQUIPMENT	G40.	G41.
	21. <input type="checkbox"/> BROOM	G42.	G43.
	22. <input type="checkbox"/> SHOVEL	G44.	G45.
	23. <input type="checkbox"/> SHOP VAC	G46.	G47.
	24. <input type="checkbox"/> EXHAUST HOOD	G48.	G49.
	25. <input type="checkbox"/> EMERGENCY SUMP / HOLDING TANK	G50.	G51.
	26. <input type="checkbox"/> CHEMICAL NEUTRALIZERS	G52.	G53.
	27. <input type="checkbox"/> GAS CYLINDER LEAK REPAIR KIT	G54.	G55.
	28. <input type="checkbox"/> SPILL OVERPACK DRUMS	G56.	G57.
29. <input type="checkbox"/> OTHER	G58.	G59.	
<b>Communications and Alarm Systems</b>	30. <input type="checkbox"/> TELEPHONES (Includes cellular)	G60.	G61.
	31. <input type="checkbox"/> INTERCOM / PA SYSTEM	G62.	G63.
	32. <input type="checkbox"/> PORTABLE RADIOS	G64.	G65.
	33. <input type="checkbox"/> AUTOMATIC ALARM CHEMICAL MONITORING EQUIPMENT	G66.	G67.
<b>Other</b>	34. <input type="checkbox"/> OTHER	G68.	G69.
	35. <input type="checkbox"/> OTHER	G70.	G71.

### H. EARTHQUAKE VULNERABILITY

Identify areas of the facility that are vulnerable to hazardous materials releases / spills due to earthquake-related motion. These areas require immediate isolation and inspection.

VULNERABLE AREAS: (Check all that apply) <input type="checkbox"/> 1. HAZARDOUS MATERIALS / WASTE STORAGE AREA <input type="checkbox"/> 2. PROCESS LINES / PIPING <input type="checkbox"/> 3. LABORATORY <input type="checkbox"/> 4. WASTE TREATMENT AREA	H1.	LOCATIONS (e.g., shop, outdoor shed, forensic lab)	
			H2.
			H3.
			H4.
			H5.

Identify mechanical systems vulnerable to releases / spills due to earthquake-related motion. These systems require immediate isolation and inspection.

VULNERABLE SYSTEMS: (Check all that apply) <input type="checkbox"/> 1. SHELVES, CABINETS AND RACKS <input type="checkbox"/> 2. TANKS (EMERGENCY SHUTOFF) <input type="checkbox"/> 3. PORTABLE GAS CYLINDERS <input type="checkbox"/> 4. EMERGENCY SHUTOFF AND/OR UTILITY VALVES <input type="checkbox"/> 5. SPRINKLER SYSTEMS <input type="checkbox"/> 6. STATIONARY PRESSURIZED CONTAINERS (e.g., Propane dispensing tank)	H6.	LOCATIONS	
			H7.
			H8.
			H9.
			H10.
			H11.
			H12.

### I. EMPLOYEE TRAINING

**Explanation of Requirement:** Employee training is required for all employees handling hazardous materials and hazardous wastes in day-to-day or clean-up operations including volunteers and/or contractors. Training must be:

- Provided within 6 months for new hires;
- Amended as necessary prior to change in process or work assignment;
- Given upon modification to the Emergency Response / Contingency Plan, and updated/refreshed annually for all employees.

Required content includes all of the following:

- |   |  |
|---|--|
| <ul style="list-style-type: none"> <li>• Material Safety Data Sheets;</li> <li>• Hazard communication related to health and safety;</li> <li>• Methods for safe handling of hazardous substances;</li> <li>• Fire hazards of materials / processes;</li> <li>• Conditions likely to worsen emergencies;</li> <li>• Coordination of emergency response;</li> <li>• Notification procedures;</li> <li>• Applicable laws and regulations;</li> </ul> | <ul style="list-style-type: none"> <li>• Communication and alarm systems;</li> <li>• Personal protective equipment;</li> <li>• Use of emergency response equipment (e.g. Fire extinguishers, respirators, etc.);</li> <li>• Decontamination procedures;</li> <li>• Evacuation procedures;</li> <li>• Control and containment procedures;</li> <li>• UST monitoring system equipment and procedures (if applicable).</li> </ul> |
|---|--|

INDICATE HOW EMPLOYEE TRAINING PROGRAM IS ADMINISTERED (Check all that apply)	11.
<input type="checkbox"/> 1. FORMAL CLASSROOM; <input type="checkbox"/> 2. VIDEOS; <input type="checkbox"/> 3. SAFETY / TAILGATE MEETINGS;	
<input type="checkbox"/> 4. STUDY GUIDES / MANUALS (Specify): _____	12.
<input type="checkbox"/> 5. OTHER (Specify): _____	13.
<input type="checkbox"/> 6. NOT APPLICABLE BECAUSE FACILITY HAS NO EMPLOYEES	

**Large Quantity Generator (LQG) Training Records:** Large quantity hazardous waste generators (i.e., who generate more than 270 gallons/1,000 kilograms of hazardous waste per month) must retain written documentation of employee hazardous waste management training sessions which includes:

- A written outline/agenda of the type and amount of both introductory and continuing training that will be given to persons filling each job position having responsibility for the management of hazardous waste (e.g., labeling, manifesting, compliance with accumulation time limits, etc.).
- The name, job title, and date of training for each hazardous waste management training session given to an employee filling such a job position; and
- A written job description for each of the above job positions that describes job duties and the skills, education, or other qualifications required of personnel assigned to the position.
- Current employee training records must be retained until closure of the facility.
- Former employee training records must be retained at least three years after termination of employment.

### J. LIST OF ATTACHMENTS

(Check one of the following) <input type="checkbox"/> 1. NO ATTACHMENTS ARE REQUIRED; <i>or</i> <input type="checkbox"/> 2. THE FOLLOWING DOCUMENTS ARE ATTACHED:	J1.
	J2.

### K. SIGNATURE / CERTIFICATION

**Certification:** Based on my inquiry of those individuals responsible for obtaining the information, I certify under penalty of law that I have personally examined and am familiar with the information submitted and believe the information is true, accurate, and complete, and that a copy is available on site.

SIGNATURE OF OWNER/OPERATOR	DATE SIGNED	
		K1.
NAME OF SIGNER (print)	TITLE OF SIGNER	
K2.		K3.

# HAZARDOUS MATERIALS RELATED EMERGENCY PROCEDURES

(HAZMAT FIRES, SPILLS, MEDICAL)

**Emergency:** an incident of any size that presents an immediate risk to life, the environment or property.

EVACUATE the affected areas.

STAY upwind.

DO NOT approach the involved material.

**CALL 911** and report the emergency.

- Exact location of spill (building and room number).
- Name of material involved and quantity.
- Exposures or injuries.
- Areas of concern (e.g., preschool, classroom).
- Your name and call-back number.

**CALL** the **FACILITY EMERGENCY COORDINATOR** and report the incident. The Emergency Coordinator can be reached through Campus Security via the "Blue Phones" or by calling 242-7910, 8:00 a.m. - midnight Monday - Friday; 8:30 a.m. - 5:30 p.m. Saturday. Otherwise contact the Emergency Coordinator directly using the numbers below.

Emergency Coordinator		Office Phone	24-hour Phone
<b>Primary EC</b>	<b>Andy Brown</b>	<b>242-7920</b>	<b>(530) 410-1968</b>
<b>1st Alternate</b>	<b>Craig Richie</b>	<b>242-7916</b>	
<b>2nd Alternate</b>	<b>Joe Trompczynski</b>	<b>242-7948</b>	<b>530-949-8279</b>
<b>3rd Alternate</b>	<b>Kody Turner</b>	<b>242-7930</b>	

The Emergency Coordinator will provide any needed Shasta College resources and will liaison with emergency responders.

**Minor Emergency:** an incident of a nature that does not immediately present a risk to life, environment or property but will require personal protective equipment for mitigation and clean-up.

ISOLATE the area to prevent contamination.

TRY TO CONTROL THE EMERGENCY *if you are trained to do so and you can do so safely.*

**CALL** the **FACILITY EMERGENCY COORDINATOR** and report the incident (Emergency Coordinators listed above).

## EMERGENCY AGENCIES

**OES State Warning Center**  
**Shasta County Environmental Health**

**(800) 852-7550**  
**225-5787**

This document is only a summary of emergency procedures. Refer to the Shasta College Emergency/Contingency Plan for detailed procedures.