



Shasta College

Measure H Bond Projects Update

**Presented at the
President's Cabinet Meeting
8/10/2021**

Bond Project Planning

2021 - 2029

			Fully Budgeted		\$4,900,000		\$8,500,000		\$5,800,000 (If State Funding Available)		\$4,700,000 Light Renovation	
	PRELIMINARY SCHEDULES											
	BLOCK 7		200		800		100		1600		1400	
	BEGIN	END	BEGIN	END	BEGIN	END	BEGIN	END	BEGIN	END	BEGIN	END
Project Kickoff			10/1/2020		8/1/2021		9/1/2022		8/1/2023		8/1/2023	
Pre-Design/Programming			10/1/2020	1/15/2021	8/1/2021	10/15/2021	9/1/2022	11/30/2022	8/1/2023	10/31/2023	8/1/2023	10/31/2023
Preliminary Plans			1/16/2021	2/18/2021	10/18/2021	2/28/2022	12/1/2022	2/28/2023	11/1/2023	2/29/2024	11/1/2023	2/29/2024
Working Drawings			2/19/2021	8/31/2021	3/1/2022	7/31/2022	3/1/2023	7/31/2023	3/1/2024	7/31/2024	3/1/2024	7/31/2024
DSA Submittal			9/1/2021	9/1/2021	8/1/2022	8/1/2022	8/1/2023	8/1/2023	8/1/2024	8/1/2024	8/1/2024	8/1/2024
DSA Review			9/2/2021	10/31/2021	8/2/2022	2/28/2023	8/2/2023	2/29/2024	8/2/2024	2/28/2025	8/2/2024	2/28/2025
DSA Corrections			10/31/2021	11/30/2021	2/28/2023	3/31/2023	2/29/2024	3/31/2024	2/28/2025	3/31/2025	2/28/2025	3/31/2025
DSA Approval			12/31/2021	12/31/2021	4/1/2023	4/1/2023	4/1/2024	4/1/2024	4/1/2025	4/1/2025	4/1/2025	4/1/2025
Out to Bid			1/26/2022	2/23/2022	5/24/2023	6/21/2023	4/24/2024	5/22/2024	5/21/2025	6/18/2025	5/26/2027	6/23/2027
Board Item Due/Approval			2/23/2022	3/9/2022	6/26/2023	7/12/2023	5/27/2024	6/12/2024	6/23/2025	7/9/2025	6/28/2027	7/14/2027
MOVE OUT			12/31/21		6/1/2023		6/1/2024		7/1/2025		7/15/2027	
Award Contract			3/9/2022	3/10/2022	7/12/2023	7/13/2023	6/12/2024	6/13/2024	7/9/2025	7/10/2025	7/14/2027	7/15/2027
Construction Begins/Ends	8/1/2021	12/31/2022	4/1/2022	3/31/2024	8/1/2023	12/31/2024	7/1/2024	12/31/2025	8/1/2025	5/31/2027	9/1/2027	5/31/2029
DSA Close Out			4/1/2024	4/30/2024	1/1/2025	1/31/2025	1/1/2026	1/31/2026	6/1/2027	6/30/2027	6/1/2029	6/30/2029
Complete Project	12/31/2022	3/31/2023	4/30/2024	4/30/2024	1/31/2025	1/31/2025	1/31/2026	1/31/2026	6/30/2027	6/30/2027	6/30/2029	6/30/2029
MOVE BACK IN	3/31/2023		6/1/2024		6/1/2025		6/1/2026		7/1/2027		7/1/2029	
SWING SPACE UTILIZED	2100 (50%) / 1300		2100 (50%) /2200		1300 / 2100 (50%)		2100 (50%)/2200/2300 VP Off		1300 / 2100 (50%)		1300/2100/2200	
			2020-2021		2021-2022				2023-2024			
			State Funding		State Funding				State Funding			

Planned projects, and estimated timeframes, are subject to change...



Bond Project Planning *(continued)*

SWING SPACE - 1300, 2100, 2200, 2300 VP Office	
EWD to 2100 (50%)	Jun-21
2200 (BAITS Div Off, CIS & BUS Faculty) to 1000 (CIS Bldg)	Oct-21
200 (Library, Ed Tech, GTC, Coll Conn) to 2100 (50%) / 2200	Dec 2021-Jan 2022
Dr. Mahar & Team to 1300	Dec 2021-Jan 2022
2100 (50%) (EWD, Research, Found, NST) to BLOCK 7	Mar-23
Dr. Mahar & Team to BLOCK 7	Mar-23
800 to 1300 / 2100 (50%)	Jun-23
700 / 2100 (50%) / 2200 (Library, Ed Tech, Tutoring Centers) to 200	Jun-24
100 to 2100 (50%) (2165 Board Room)/2200 / 2300 VP Suite	Jul-24
100 Non-Student Svcs to 700	Dec 2025-Jan 2026
1300 / 2100 (50%) to 800	Jun-25
1600 to 1300 / 2100 (50%)	Jul-25
2100 (50%) / 2200 / 2300 - Stu Svcs to 100	Jun-26
1300 / 2100 (50%) to 1600	Jul-27
1400 to 1300 / 2100 / 2200	Jul-27
1300 / 2100 / 2200 to 1400	Jul-29

Swing Space Planning – Bond Program Office / Physical Plant / Constituents



Bond Project Planning *(continued)*

	Jun-21	December 2021 / January 2022	Mar-23	Jun-23	Jun-24	Jul-24	December 2025/ January 2026	Jun-25	Jul-25	Jun-26	Jul-27	Jul-27	Jul-29
2100	EWD	EWD	EWD	800 Bldg Faculty/ Services	800 Bldg Faculty/ Services	800 Bldg Faculty/ Services	800 Bldg Faculty/ Services	800 Bldg Faculty/ Services	1600 Bldg Faculty	1600 Bldg Faculty	1600 Bldg Faculty		
		Library/GTC/CC	Library/GTC/CC	Library/GTC/CC	Library/GTC/CC	100 Bldg Stu Svcs / Other Offices	100 Bldg Other Offices to 700	100 Bldg Stu Svcs	100 Bldg Stu Svcs	100 Bldg Stu Svcs			
2200		Library/GTC/CC	Library/GTC/CC	Library/GTC/CC	Library/GTC/CC	100 Bldg Stu Svcs / Other Offices	100 Bldg Other Offices to 700	100 Bldg Stu Svcs	100 Bldg Stu Svcs	100 Bldg Stu Svcs		1400 Bldg Faculty	1400 Bldg Faculty
1300		Dr. Mahar & Team	Dr. Mahar & Team	800 Bldg Faculty/ Services	800 Bldg Faculty/ Services	800 Bldg Faculty/ Services	800 Bldg Faculty/ Services	800 Bldg Faculty/ Services	1600 Bldg Faculty	1600 Bldg Faculty	1600 Bldg Faculty	1400 Bldg Faculty	1400 Bldg Faculty
2300 VP Suite						100 Bldg Stu Svcs / Other Offices	100 Bldg Other Offices to 700	100 Bldg Stu Svcs	100 Bldg Stu Svcs	100 Bldg Stu Svcs			

SWING SPACE MOVES – CONSIDERATIONS

- Coordinated move logistics
 - Master Schedule (one point of contact?)
 - Physical Plant Work Orders
 - Technology Help Tickets
 - Furniture Installer / Contracted Movers Scheduling
- Gateway to College and College Connections – “permanent” home in 2100?



Bond Project Planning *(continued)*

MOVE OUT	1. Technology	Remove & store staff/services/classroom technology
	2. Physical Plant / Furniture Installer / Contracted Movers	Staff furniture/other non-furniture items to temporary space Remaining furniture to climatized storage or surplus
	3. Technology	Staff/services/classroom technology moved to and set up in temporary space
	4. Physical Plant / Staff	Boxed files/staff personal items/other items to temporary space
MOVE IN	1. Furniture Installer	New furniture delivered, assembled and installed Repurposed furniture installed
	2. Physical Plant / Contracted Movers	Other non-furniture items to new space
	3. Technology	Staff/services/classroom technology moved to and set up in new space
	4. Physical Plant / Staff	Boxed files/staff personal items/other items to new space



Bond Project Planning *(continued)*

\$4,900,000	\$8,500,000	\$5,800,000 (If State Funding Available)	\$4,700,000 Light Renovation	\$23,900,000
PRELIMINARY SCHEDULES				
800	100	1600	1400	

Remaining Funds – Issuances A, B & C = \$23,934,023

September 7, 2017 - July 31, 2021

Bond Income/Outflow

Tax Exempt Series

Bond Sales Series A (9/7/2017)	\$ 50,000,000
Series A Net Issuance Costs	(208,359)
Bond Sales Series B (10/3/2019)	20,000,000
Series B Issuance Costs	(119,820)
Bond Sales Series C (12/9/2020)	10,000,000
Series C Issuance Costs	(59,167)
Refunded 2009A/2008A Bonds	(7,987,268)
Additional Funds from Other Sources	474,795
Transfer of Interest for Expenses	0
Net Available Funds for Projects	\$ 72,100,180
Encumbrances	(3,016,289)
Project Expenditures to Date	(53,239,954) *
Budget Remaining	(12,232,200)
Ending Available Funds for Projects	\$ 3,611,738

*Includes \$266,362 Reimbursement Allocation

Taxable Series

Bond Sales Series B-1 (10/3/2019)	\$ 20,000,000
Series B-1 Issuance Costs	(188,882)
Bond Sales Series C-1 (12/9/2020)	\$ 20,000,000
Series C-1 Issuance Costs	(198,333)
Net Available Funds for Projects	\$ 39,612,785
Encumbrances	(13,918,901)
Project Expenditures to Date	(3,518,499)
Budget Remaining	(1,853,100)
Ending Available Funds for Projects	\$ 20,322,285

Interest Proceeds for Future Allocation

Fiscal Year	Tax Exempt Series	Taxable Series	Total Int. Proceeds
2017-2018	\$391,254		
2018-2019	544,057		
2019-2020	532,899	\$265,308	
2020-2021	243,083	307,428	
TOTAL	\$1,711,293	\$572,736	\$2,284,029



Bond Project Planning *(continued)*

Issuance D Remaining - \$19 Million

How are we maximizing Bond \$\$\$?

- State Funding (\$19.9 Million) - \$15.6 million for Library Renovation
\$ 4.3 million for 800 Building Renovation
- Potential State Funding (\$14.5 M) - \$5.2 million for 1600 Building Renovation
\$9.3 million for Theatre Complex Reconstruction
- Stimulus Funds contributing to Projects (Est. \$3 million)
- Interest Earned on Bond Proceeds in County Treasury (Est. \$4.5 million)
- Strong Workforce Program Funding (\$358,000), CCCCCO, Fire Chief's Association Contributions
- Potential Scheduled Maintenance Funds contributing to Bond Projects (amount TBD)



Bond Project Planning *(continued)*

Remaining Potential Projects In Numeric/Alpha Order *(not in order of priority)*

- ✓ 300 (Art) Building Renovation
- ✓ 400-500-600 Theatre Complex Reconstruction (IPP submitted to CCCCCO)
- ✓ 700 (Administration) Building Refresh
- ✓ 900 (Faculty Offices) Building Refresh
- ✓ 1100 (Math) Building Renovation
- ✓ 1200 (Natural Resources/Trades) Building Renovation
- ✓ 1300 (GIS/Geography/Engineering) Building Renovation
- ✓ 1800 (PE Offices/Training Rooms/Lockers Rooms) Renovation
- ✓ 2000 (Campus Center) Renovation
- ✓ 2300 (Dean of Students/Bookstore) Refresh
- ✓ Farm Portable Classroom and Restrooms
- ✓ Main Campus Signage Project
- ✓ Red Bluff Land Purchase & Improvements

This is not a
comprehensive list...



CIS Building



Project Start:
1/2020
Estimated Completion:
9/2021

JK ARCHITECTURE
ENGINEERING
ARCHITECT



CONTRACTOR



CIS Building *(continued)*



Exterior Lighting
Installed



CIS Building *(continued)*



Student Data
Room



CIS Building *(continued)*



Doors and flooring
being installed



Downtown Redding Office Building Purchase



Building Foundation



Estimated
Building
Completion: 12/22

Estimated
Parking Garage
Completion: 11/21



200 Building (Library) Renovation

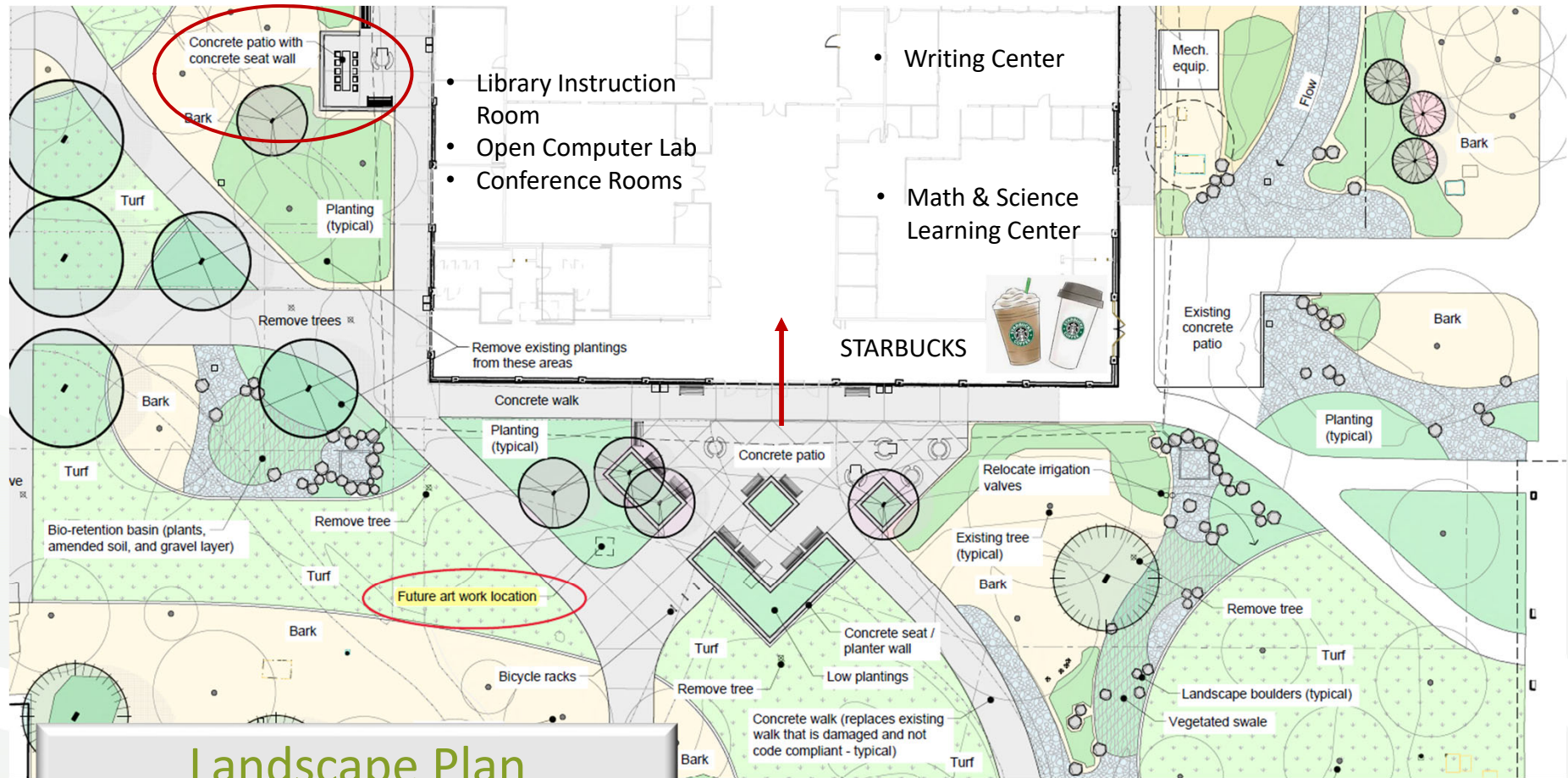

Landscape Plan
Front Entry



Other Projects

Other Projects

- **Solar Project – East Parking Lot** (project complete and undergoing PG&E testing)
- **SC Main Campus Keying & Access Control** (Phase II - door hardware received and to be installed in the fall; Phase III – Electronic access equipment (AMAG) purchase and installation to move forward soon)
- **SC Main Campus Building Site Mitigation** (RPSTC and CTE landscaping will be included in the construction bid)



Completed Projects

- 200 Building Exterior Infrastructure/ADA Walkway/Patio Project
- 2400 Building Electrical Upgrade
- Athletic Fieldhouse with Restrooms
- Campus Safety Relocation – Interior Remodel
- Campus Safety Site Work and ADA Paths of Travel
- CTE Building and Covered Storage
- Dorms Upgrade Project
- Farm Building 4500 Shade Structure
- Gymnasium Air Conditioning
- HSUC Folding Wall Replacement
- Interior/Exterior Lighting Project – Prop 39 & Bond
- Northeast Campus Infrastructure
- Regional Public Safety Training Center – Phase I



Completed Projects *(continued)*

- Regional Public Safety Training Center – Classroom Buildings
- SC Main Campus Fiber Upgrade
- SC Main Campus Keying & Access Control (Wiring Phase)
- SC Safety & Security Standards
- Shasta College Storage Building
- Summer 2019 Infrastructure Project
- Tehama Campus Student Services Building
- Veterans Support & Success Center Building



For more information...



About / Bond Projects / Measure H

Theresa Markword,
Bond Program Manager
tmarkword@shastacollege.edu
(530) 242-7699

Emily Booth,
Bond Program
Administrative Asst.
ebooth@shastacollege.edu
(530) 242-7747

