



Shasta College

Measure H Bond Projects Update

Presented at the
Instructional Deans Meeting
8/5/2021

Bond Project Planning

2021 - 2029

| | | Fully Budgeted | \$4,900,000 | \$8,500,000 | \$5,800,000 (If State Funding Available) | \$4,700,000 Light Renovation | | | | | |
|--------------------------|----------------------|----------------------|----------------------|-----------------------------|---|---------------------------------|------------|-----------------|------------|------------------|------------|
| PRELIMINARY SCHEDULES | | | | | | | | | | | |
| BLOCK 7 | | 200 | | 800 | | 100 | | 1600 | | 1400 | |
| BEGIN | END | BEGIN | END | BEGIN | END | BEGIN | END | BEGIN | END | BEGIN | END |
| Project Kickoff | | 10/1/2020 | | 8/1/2021 | | 9/1/2022 | | 8/1/2023 | | 8/1/2023 | |
| Pre-Design/Programming | | 10/1/2020 | 1/15/2021 | 8/1/2021 | 10/15/2021 | 9/1/2022 | 11/30/2022 | 8/1/2023 | 10/31/2023 | 8/1/2023 | 10/31/2023 |
| Preliminary Plans | | 1/16/2021 | 2/18/2021 | 10/18/2021 | 2/28/2022 | 12/1/2022 | 2/28/2023 | 11/1/2023 | 2/29/2024 | 11/1/2023 | 2/29/2024 |
| Working Drawings | | 2/19/2021 | 8/31/2021 | 3/1/2022 | 7/31/2022 | 3/1/2023 | 7/31/2023 | 3/1/2024 | 7/31/2024 | 3/1/2024 | 7/31/2024 |
| DSA Submittal | | 9/1/2021 | 9/1/2021 | 8/1/2022 | 8/1/2022 | 8/1/2023 | 8/1/2023 | 8/1/2024 | 8/1/2024 | 8/1/2024 | 8/1/2024 |
| DSA Review | | 9/2/2021 | 10/31/2021 | 8/2/2022 | 2/28/2023 | 8/2/2023 | 2/29/2024 | 8/2/2024 | 2/28/2025 | 8/2/2024 | 2/28/2025 |
| DSA Corrections | | 10/31/2021 | 11/30/2021 | 2/28/2023 | 3/31/2023 | 2/29/2024 | 3/31/2024 | 2/28/2025 | 3/31/2025 | 2/28/2025 | 3/31/2025 |
| DSA Approval | | 12/31/2021 | 12/31/2021 | 4/1/2023 | 4/1/2023 | 4/1/2024 | 4/1/2024 | 4/1/2025 | 4/1/2025 | 4/1/2025 | 4/1/2025 |
| Out to Bid | | 1/26/2022 | 2/23/2022 | 5/24/2023 | 6/21/2023 | 4/24/2024 | 5/22/2024 | 5/21/2025 | 6/18/2025 | 5/26/2027 | 6/23/2027 |
| Board Item Due/Approval | | 2/23/2022 | 3/9/2022 | 6/26/2023 | 7/12/2023 | 5/27/2024 | 6/12/2024 | 6/23/2025 | 7/9/2025 | 6/28/2027 | 7/14/2027 |
| MOVE OUT | | 12/31/21 | | 6/1/2023 | | 6/1/2024 | | 7/1/2025 | | 7/15/2027 | |
| Award Contract | | 3/9/2022 | 3/10/2022 | 7/12/2023 | 7/13/2023 | 6/12/2024 | 6/13/2024 | 7/9/2025 | 7/10/2025 | 7/14/2027 | 7/15/2027 |
| Construction Begins/Ends | 8/1/2021 12/31/2022 | 4/1/2022 3/31/2024 | 8/1/2023 12/31/2024 | 7/1/2024 12/31/2025 | 8/1/2025 5/31/2027 | 9/1/2027 5/31/2029 | | | | | |
| DSA Close Out | | 4/1/2024 4/30/2024 | 1/1/2025 1/31/2025 | 1/1/2026 1/31/2026 | 6/1/2027 6/30/2027 | 6/1/2029 6/30/2029 | | | | | |
| Complete Project | 12/31/2022 3/31/2023 | 4/30/2024 4/30/2024 | 1/31/2025 1/31/2025 | 1/31/2026 1/31/2026 | 6/30/2027 6/30/2027 | 6/30/2029 6/30/2029 | | | | | |
| MOVE BACK IN | 3/31/2023 | 6/1/2024 | | 6/1/2025 | | 6/1/2026 | | 7/1/2027 | | 7/1/2029 | |
| SWING SPACE UTILIZED | 2100 (50%) / 1300 | 2100 (50%) /2200 | 1300 / 2100 (50%) | 2100 (50%)/2200/2300 VP Off | 1300 / 2100 (50%) | 1300/2100/2200 | | | | | |
| | | 2020-2021 | 2021-2022 | 2023-2024 | | | | | | | |
| | | State Funding | State Funding | State Funding | | | | | | | |

Planned projects, and estimated timeframes, are subject to change...



Bond Project Planning *(continued)*

| SWING SPACE - 1300, 2100, 2200, 2300 VP Office | |
|---|-------------------|
| EWD to 2100 (50%) | Jun-21 |
| 2200 (BAITS Div Off, CIS & BUS Faculty) to 1000 (CIS Bldg) | Oct-21 |
| 200 (Library, Ed Tech, GTC, Coll Conn) to 2100 (50%) / 2200 | Dec 2021-Jan 2022 |
| Dr. Mahar & Team to 1300 | Dec 2021-Jan 2022 |
| 2100 (50%) (EWD, Research, Found, NST) to BLOCK 7 | Mar-23 |
| Dr. Mahar & Team to BLOCK 7 | Mar-23 |
| 800 to 1300 / 2100 (50%) | Jun-23 |
| 700 / 2100 (50%) / 2200 (Library, Ed Tech, Tutoring Centers) to 200 | Jun-24 |
| 100 to 2100 (50%) (2165 Board Room)/2200 / 2300 VP Suite | Jul-24 |
| 100 Non-Student Svcs to 700 | Dec 2025-Jan 2026 |
| 1300 / 2100 (50%) to 800 | Jun-25 |
| 1600 to 1300 / 2100 (50%) | Jul-25 |
| 2100 (50%) / 2200 / 2300 - Stu Svcs to 100 | Jun-26 |
| 1300 / 2100 (50%) to 1600 | Jul-27 |
| 1400 to 1300 / 2100 / 2200 | Jul-27 |
| 1300 / 2100 / 2200 to 1400 | Jul-29 |

Swing Space Planning – Bond Program Office / Physical Plant / Constituents



Bond Project Planning *(continued)*

| | Jun-21 | December 2021 / January 2022 | Mar-23 | Jun-23 | Jun-24 | Jul-24 | December 2025/ January 2026 | Jun-25 | Jul-25 | Jun-26 | Jul-27 | Jul-27 | Jul-29 |
|------------------|--------|---------------------------------|------------------|-------------------------------|-------------------------------|--------------------------------------|----------------------------------|-------------------------------|-------------------|-------------------|-------------------|-------------------|-------------------|
| 2100 | EWD | EWD | EWD | 800 Bldg Faculty/ Services | 800 Bldg Faculty/ Services | 800 Bldg Faculty/ Services | 800 Bldg Faculty/ Services | 800 Bldg Faculty/ Services | 1600 Bldg Faculty | 1600 Bldg Faculty | 1600 Bldg Faculty | | |
| | | Library/GTC/CC | Library/GTC/CC | Library/GTC/CC | Library/GTC/CC | 100 Bldg Stu Svcs / Other Offices | 100 Bldg Other Offices to 700 | 100 Bldg Stu Svcs | 100 Bldg Stu Svcs | 100 Bldg Stu Svcs | | | |
| 2200 | | Library/GTC/CC | Library/GTC/CC | Library/GTC/CC | Library/GTC/CC | 100 Bldg Stu Svcs / Other Offices | 100 Bldg Other Offices to 700 | 100 Bldg Stu Svcs | 100 Bldg Stu Svcs | 100 Bldg Stu Svcs | | 1400 Bldg Faculty | 1400 Bldg Faculty |
| 1300 | | Dr. Mahar & Team | Dr. Mahar & Team | 800 Bldg Faculty/ Services | 800 Bldg Faculty/ Services | 800 Bldg Faculty/ Services | 800 Bldg Faculty/ Services | 800 Bldg Faculty/ Services | 1600 Bldg Faculty | 1600 Bldg Faculty | 1600 Bldg Faculty | 1400 Bldg Faculty | 1400 Bldg Faculty |
| 2300 VP Suite | | | | | | 100 Bldg Stu Svcs / Other Offices | 100 Bldg Other Offices to 700 | 100 Bldg Stu Svcs | 100 Bldg Stu Svcs | 100 Bldg Stu Svcs | | | |

Gateway to College and College Connection – Permanent Location?



Bond Project Planning *(continued)*

| | | | | |
|------------------------------|-------------|---|---------------------------------|---------------------|
| \$4,900,000 | \$8,500,000 | \$5,800,000 (If State Funding Available) | \$4,700,000 Light Renovation | \$23,900,000 |
| PRELIMINARY SCHEDULES | | | | |
| 800 | 100 | 1600 | 1400 | |

Remaining Funds – Issuances A, B & C = \$23,934,023

September 7, 2017 - July 31, 2021

Bond Income/Outflow

Tax Exempt Series

| | |
|--|----------------------|
| Bond Sales Series A (9/7/2017) | \$ 50,000,000 |
| Series A Net Issuance Costs | (208,359) |
| Bond Sales Series B (10/3/2019) | 20,000,000 |
| Series B Issuance Costs | (119,820) |
| Bond Sales Series C (12/9/2020) | 10,000,000 |
| Series C Issuance Costs | (59,167) |
| Refunded 2009A/2008A Bonds | (7,987,268) |
| Additional Funds from Other Sources | 474,795 |
| Transfer of Interest for Expenses | 0 |
| Net Available Funds for Projects | \$ 72,100,180 |
| Encumbrances | (3,016,289) |
| Project Expenditures to Date | (53,239,954) * |
| Budget Remaining | (12,232,200) |
| Ending Available Funds for Projects | \$ 3,611,738 |

*Includes \$266,362 Reimbursement Allocation

Taxable Series

| | |
|--|----------------------|
| Bond Sales Series B-1 (10/3/2019) | \$ 20,000,000 |
| Series B-1 Issuance Costs | (188,882) |
| Bond Sales Series C-1 (12/9/2020) | \$ 20,000,000 |
| Series C-1 Issuance Costs | (198,333) |
| Net Available Funds for Projects | \$ 39,612,785 |
| Encumbrances | (13,918,901) |
| Project Expenditures to Date | (3,518,499) |
| Budget Remaining | (1,853,100) |
| Ending Available Funds for Projects | \$ 20,322,285 |

Interest Proceeds for Future Allocation

| Fiscal Year | Tax Exempt Series | Taxable Series | Total Int. Proceeds |
|--------------|--------------------|------------------|---------------------|
| 2017-2018 | \$391,254 | | |
| 2018-2019 | 544,057 | | |
| 2019-2020 | 532,899 | \$265,308 | |
| 2020-2021 | 243,083 | 307,428 | |
| TOTAL | \$1,711,293 | \$572,736 | \$2,284,029 |



Bond Project Planning *(continued)*

Issuance D Remaining - \$19 Million

How are we maximizing Bond \$\$\$?

- **State Funding (\$19.9 Million) - \$15.6 million for Library Renovation
\$ 4.3 million for 800 Building Renovation**
- **Potential State Funding (\$14.5 M) - \$5.2 million for 1600 Building Renovation
\$9.3 million for Theatre Complex Reconstruction**
- **Stimulus Funds contributing to Projects (Est. \$3 million)**
- **A portion of Scheduled Maintenance Funding (amount TBD)**
- **Interest Earned on Bond Proceeds in County Treasury (Est. \$4.5 million)**
- **Strong Workforce Program Funding (\$358,000), CCCCCO, Fire Chief's Association Contributions**



CIS Building



Project Start:
1/2020

Estimated Completion:
9/2021

JK ARCHITECTURE
ENGINEERING
ARCHITECT

McCuen
CONSTRUCTION, INC.
CONTRACTOR



CIS Building *(continued)*



Exterior Lighting
Installed



CIS Building *(continued)*



Student Data
Room



CIS Building *(continued)*



Doors and flooring
being installed



Downtown Redding Office Building Purchase



Building Foundation



Estimated
Building
Completion: 12/22

Estimated
Parking Garage
Completion: 11/21



200 Building (Library) Renovation

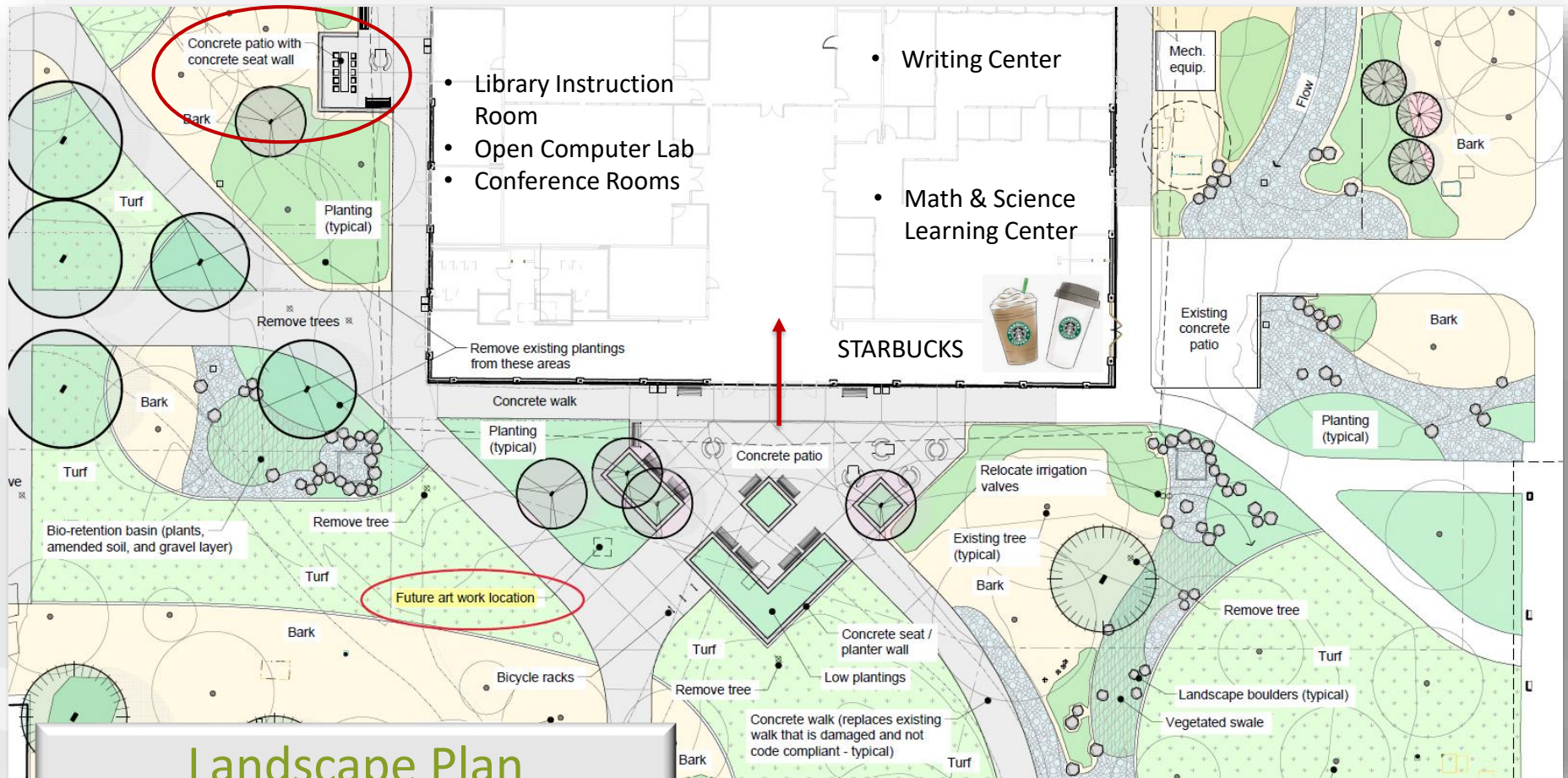

Landscape Plan
Front Entry



Other Projects

Other Projects

- **Solar Project – East Parking Lot** (project complete and undergoing PG&E testing)
- **SC Main Campus Keying & Access Control** (Phase II - door hardware received and to be installed in the fall; Phase III – Electronic access equipment (AMAG) purchase and installation to move forward soon)
- **SC Main Campus Building Site Mitigation** (RPSTC and CTE landscaping will be included in the construction bid)



Completed Projects

- **200 Building Exterior Infrastructure/ADA Walkway/Patio Project**
- **2400 Building Electrical Upgrade**
- **Athletic Fieldhouse with Restrooms**
- **Campus Safety Relocation – Interior Remodel**
- **Campus Safety Site Work and ADA Paths of Travel**
- **CTE Building and Covered Storage**
- **Dorms Upgrade Project**
- **Farm Building 4500 Shade Structure**
- **Gymnasium Air Conditioning**
- **HSUC Folding Wall Replacement**
- **Interior/Exterior Lighting Project – Prop 39 & Bond**
- **Northeast Campus Infrastructure**
- **Regional Public Safety Training Center – Phase I**



Completed Projects *(continued)*

- **Regional Public Safety Training Center – Classroom Buildings**
- **SC Main Campus Fiber Upgrade**
- **SC Main Campus Keying & Access Control (Wiring Phase)**
- **SC Safety & Security Standards**
- **Shasta College Storage Building**
- **Summer 2019 Infrastructure Project**
- **Tehama Campus Student Services Building**
- **Veterans Support & Success Center Building**



For more information...



About / Bond Projects / Measure H

Theresa Markword,
Bond Program Manager
tmarkword@shastacollege.edu
(530) 242-7699

Emily Booth,
Bond Program
Administrative Asst.
ebooth@shastacollege.edu
(530) 242-7747

